

No 36766

1053

677

R.P.O. Vol. 34
C.T. Vol. 2106

Fol. 525
Fol. 195

Ward of Turure
County of St. Andrew
Cadastral Sheet E.2.E

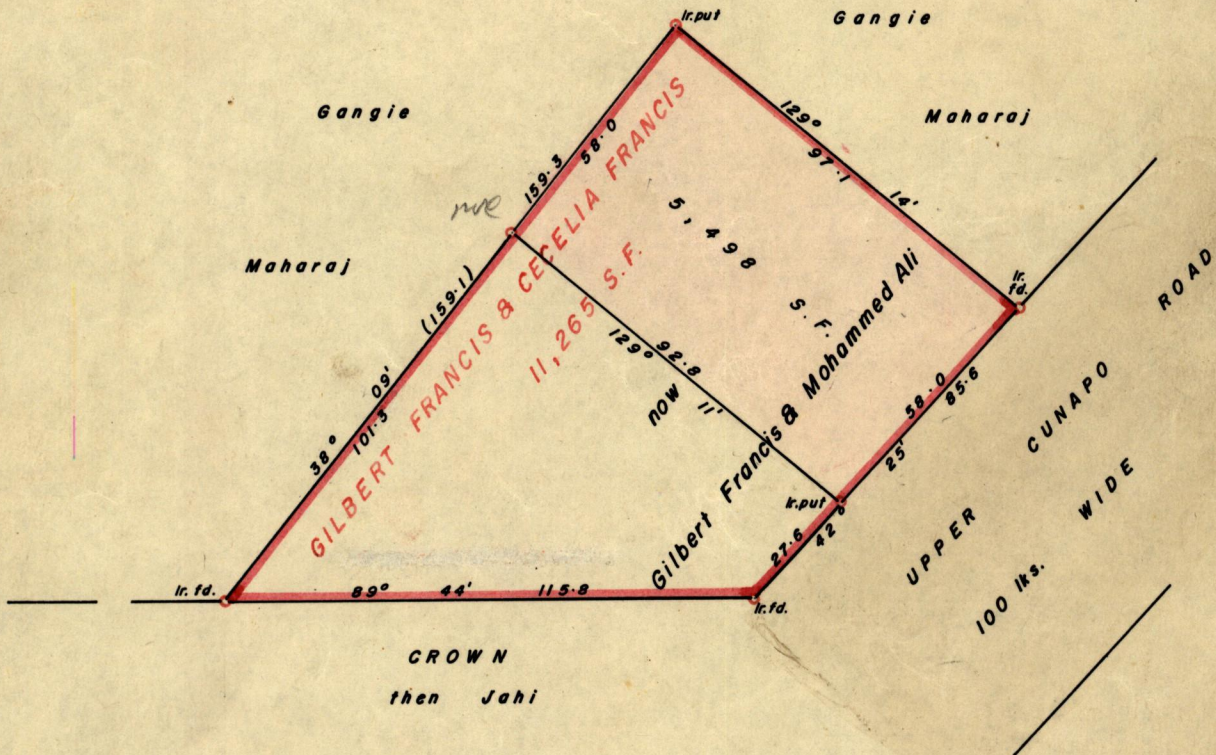

Grid North

Approved

Albert James
Director of Surveys

22.5.79

SCALE 1/500

Note: To obtain compass bearings add ~~subtract~~ 17 minutes Distances are in feet

PLAN of a Parcel of land coloured pink in the Ward of Turure
Containing five thousand, four hundred and ninety-eight square feet
Surveyed by me, with due authority, in November 1978

I certify that I have complied with rule 76 under Section 14 (2) (d) of the Land Surveyors' Ordinance 1952, and that this plan is correct.

Checked by *D.F.W. 10/5/79.*

Albert James
Land Surveyor, Trinidad

Entered.....

28 April 1979

Original Plan P. A. 74

MOHAMMED ALI + MARE MORALES