

Nº 41330

1053

611

R.P.O. Vol. 166
C.T. Vol.

Fol. 273
Fol.

Ward of Savana Grande
County of Victoria
Cadastral Sheet D.23.P

GN

INSET

SCALE 1:1250
Dist in lks

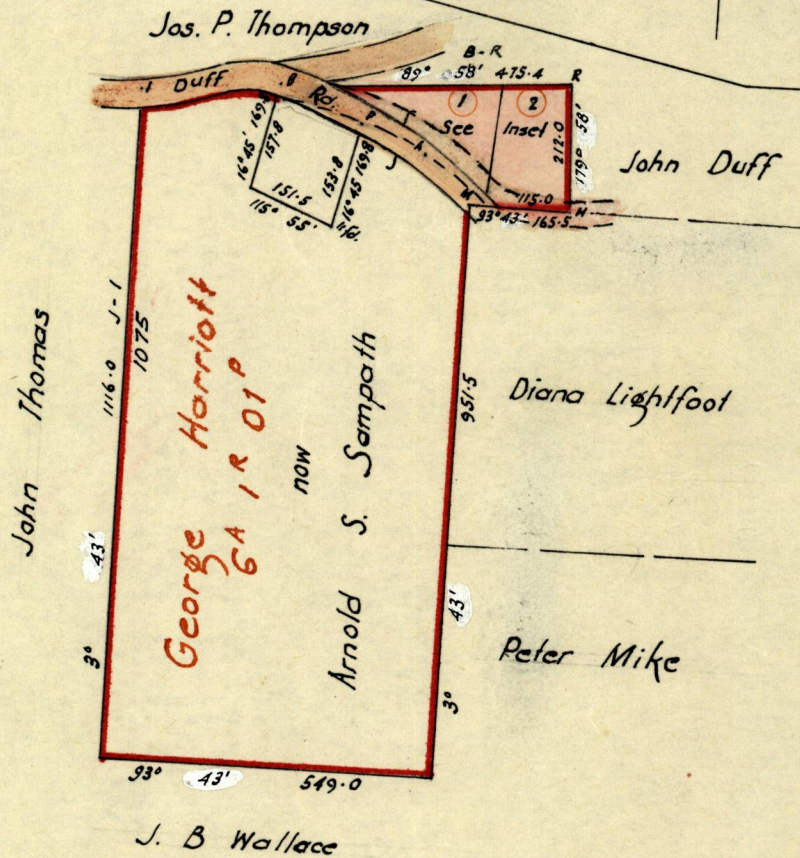
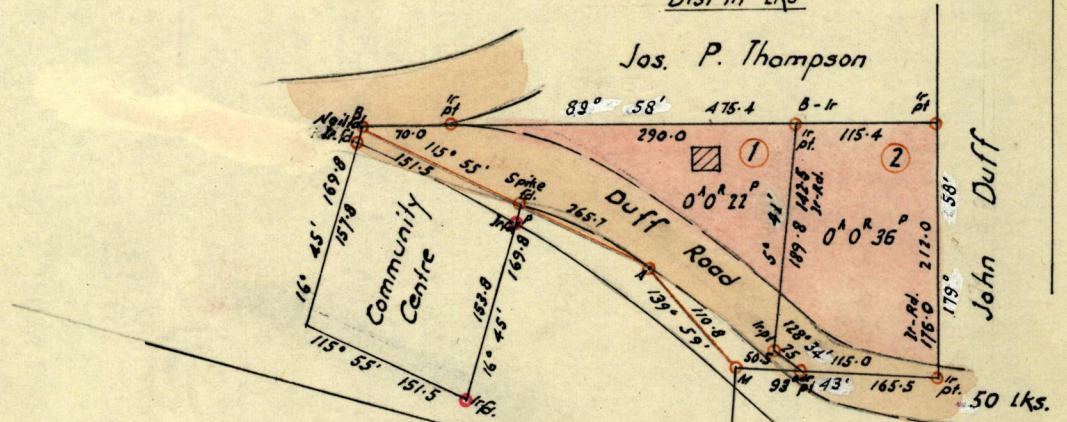

Approved

[Signature]
 28.9.78 Director of Surveys

SCALE 1:2500

Note: To obtain compass bearings ~~add~~/^{two}subtract 2 minutes Distances are in lks
 PLAN of 2 Parcelsof land coloured pink in the Ward of Savana Grande
 Containing together One rood and eighteen perches
 Surveyed by me, with due authority, in Oct. 1977

I certify that I have complied with rule 76 under Section 14 (2) (d) of the Land Surveyors' Ordinance 1952, and that this plan is correct.

Checked by *[Signature]* 26/9/78

Entered.....

Land Surveyor, Trinidad

[Signature]
 LANDS AND SURVEYS VAULT RECORDS
 1978

Original Survey Bk 352 fol 4

110

166

1023

1023

