

Nº 37056

1053

602

R.P.O. Vol. 216
C.T. Vol. 1024

Fol. 567
Fol. 209

Ward of Siparia
County of St. Patrick
Cadastral Sheet G.13. K & L

G N

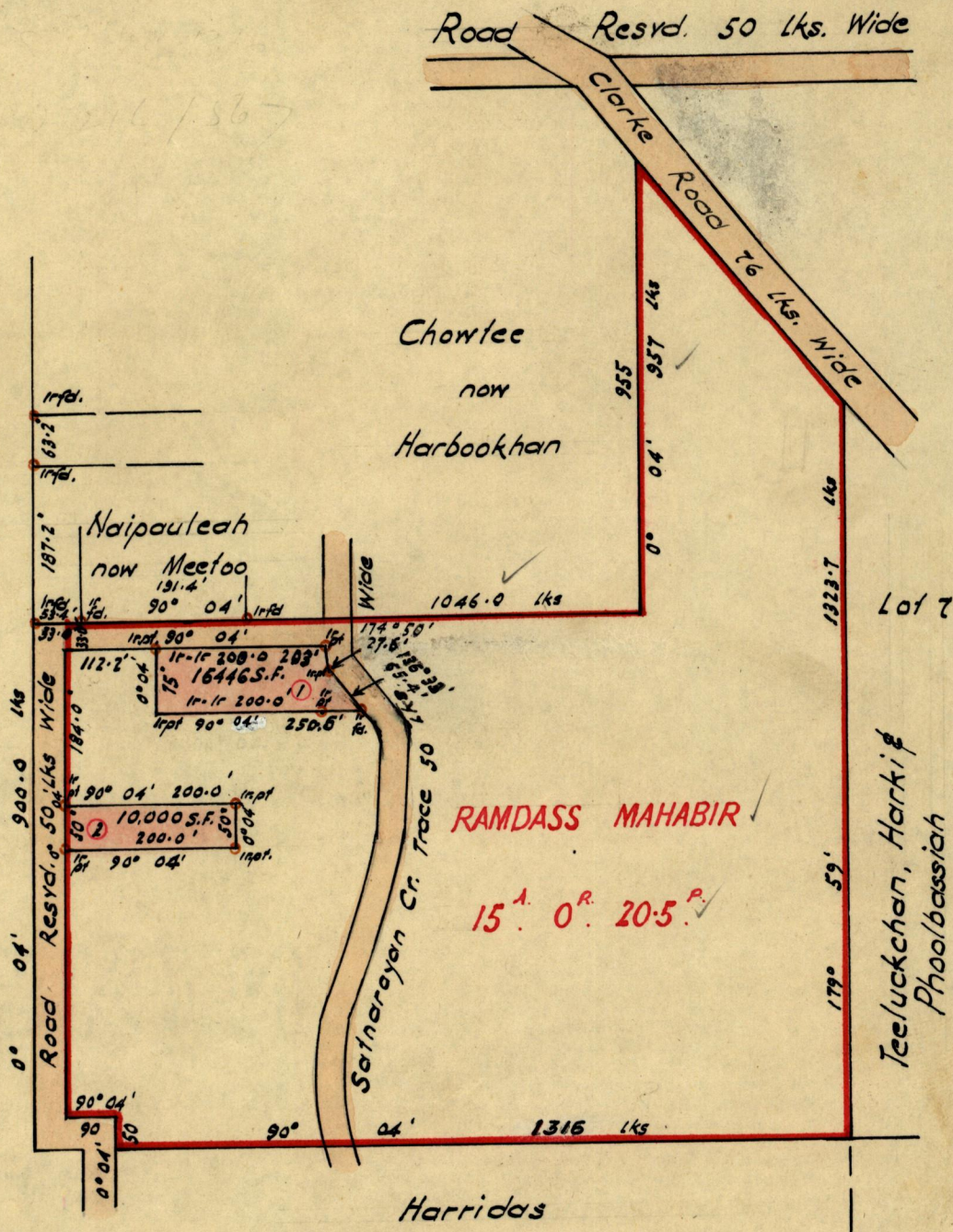

Approved

[Signature]
22-9-78 Director of Surveys

SCALE 1:2500

Note: To obtain compass bearings add/subtract 1 minutes Distances are in LKS & FT
PLAN of 2 Parcelsof land coloured pink in the Ward of Siparia
Containing Together Twenty six Thousand Four Hundred and Forty six Sq.ft.
Surveyed by me, with due authority, in June 1975

I certify that I have complied with rule 76 under Section 14 (2) (d) of the Land Surveyors' Ordinance 1952, and that this plan is correct.

Checked by *[Signature]*

Entered..... Land Surveyor, Trinidad..... 15/6/1978

LANDS AND SURVEYS VAULT RECORDS

original Survey Bk 952 fol 247

002

1023

