

1053

565

No 40847

R.P.O. Vol. 302
C.T. Vol.

Fol. 293
Fol.

Ward of Charuma
County of Nariva
Cadastral Sheet H.2.B.

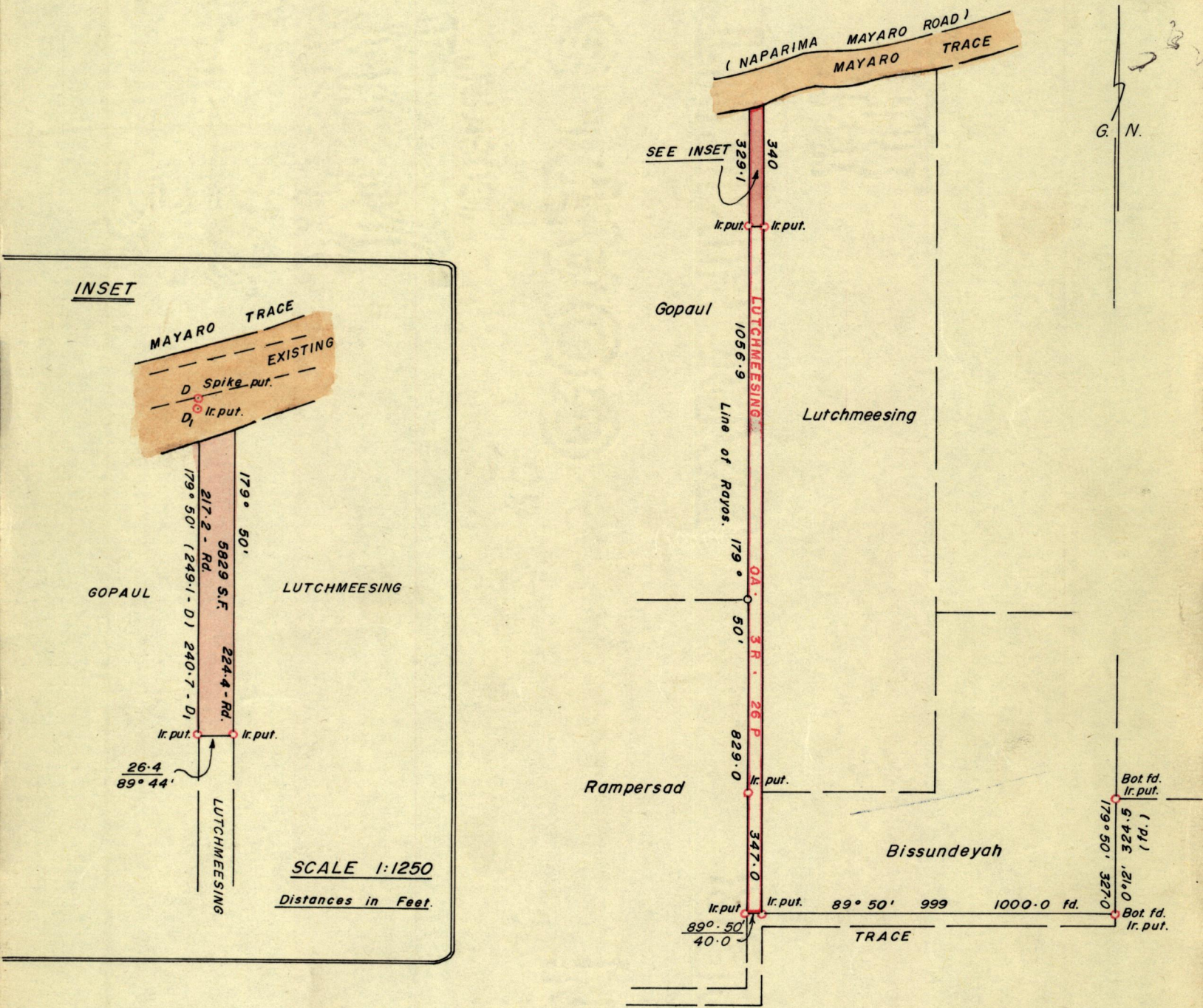

Approved

[Signature]
Director of Surveys 25.7.78.

SCALE 4 chs. — 1 inch.

Note: To obtain compass bearings add/subtract 10 minutes Distances are in links.

PLAN of a Parcel of land coloured pink in the Ward of Charuma
Containing five thousand, eight hundred and twenty nine square feet.

Surveyed by me, with due authority, in September 1977 and June 1978

I certify that I have complied with rule 76 under Section 14 (2) (d) of the Land Surveyors' Ordinance 1952, and that this plan is correct.

Checked by *L.F.D. 25/7/78*

LANDS AND SURVEYS VAULT RECORDS

Entered.....

Land Surveyor, Trinidad..... 6.7.1978

IVAN LAUGHLIN
LAND SURVEYOR

302/293

nr

Barandes Lichtrangsge

Original BK. 1103 fol 147