

1053

54

No 32265

R.P.O. Vol 1958  
C.T. Vol.

Fol. 367  
Fol.

Ward of Pointe a Pierre  
County of Victoria  
Cadastral Sheet D. 22.C

GN

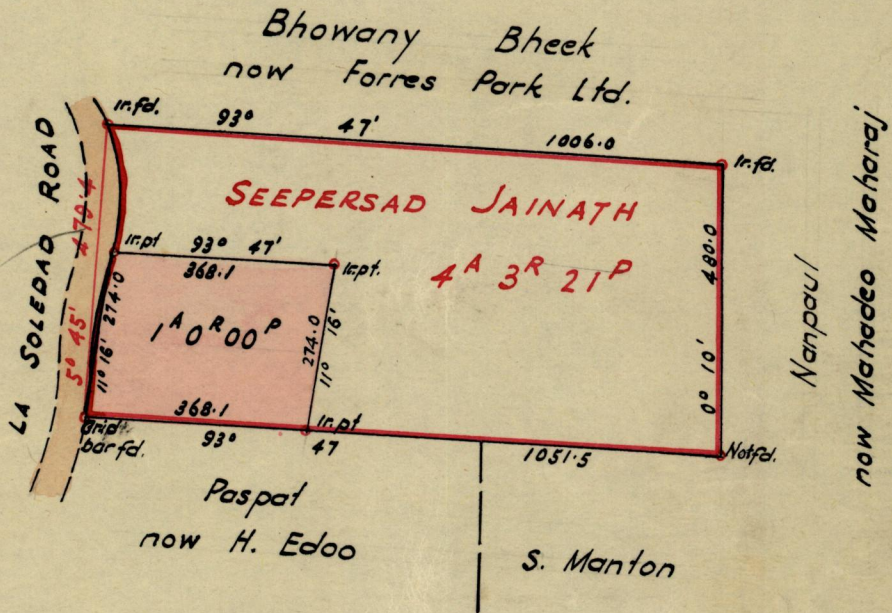

Approved

*[Signature]*

Director of Surveys  
4.11.72

SCALE 1:2500

Note: To obtain compass bearings ~~add~~/subtract 2 minutes Distances are in Lks

PLAN of a Parcel of land coloured pink in the Ward of Pointe a Pierre  
Containing One acre

Surveyed by me, with due authority, in Sept. 1972

I certify that I have complied with rule 76 under Section 14 (2) (d) of the Land  
Surveyors' Ordinance 1952, and that this plan is correct.

Checked by *[Signature]*

*[Signature]*

Entered .....

Land Surveyor, Trinidad 16<sup>th</sup> Sept. 1972

1053:54

1053 land

