

1053

528

No 37886

R.P.O. Vol. 111  
C.T. Vol. 2174

Fol. 121  
Fol. 239

Ward of Siparia  
County of St. Patrick  
Cadastral Sheet G. 12, H

GN

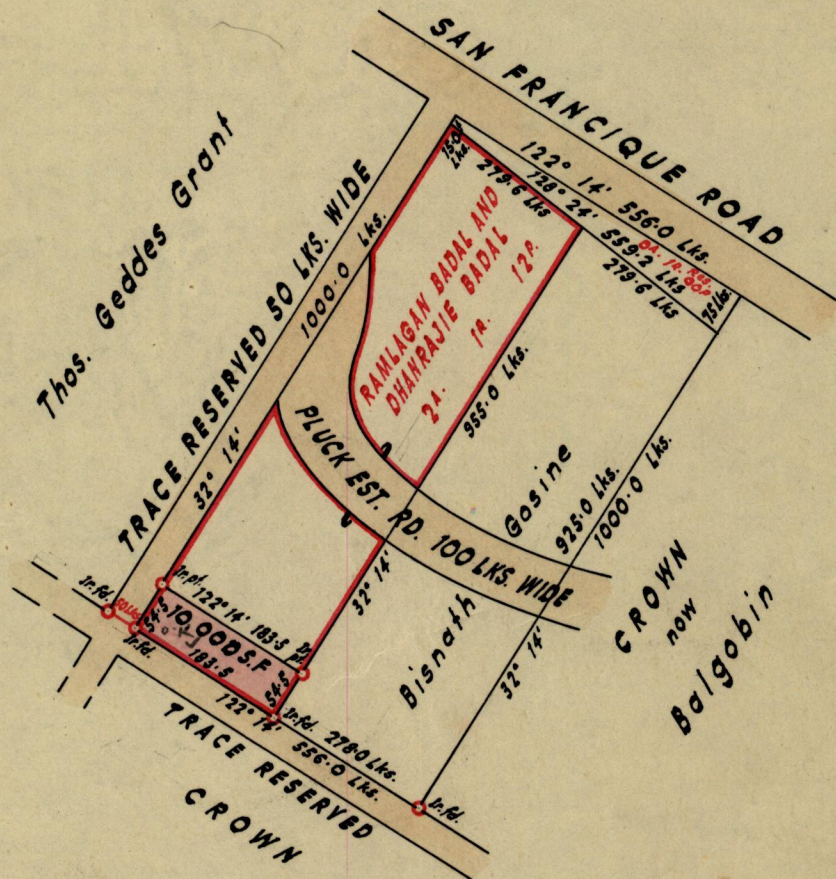

Approved

*[Signature]*  
 28.11.77 Director of Surveys

SCALE - 1 : 2500

Note: To obtain compass bearings ~~add~~ subtract 4 minutes Distances are in Lks. & Ft.

PLAN of a Parcel of land coloured Pink in the Ward of Siparia

Containing Ten Thousand Sq. Ft.

Surveyed by me, with due authority, in September 1977.

I certify that I have complied with rule 76 under Section 14 (2) (d) of the Land Surveyors' Ordinance 1952, and that this plan is correct.

Checked by *[Signature]* 23/11/77

*[Signature]*

Entered.....

Land Surveyor, Trinidad..... 15/10/1977

Original Survey Bk 1003 Vol. 164

