

Nº 39252

1053

513

R.P.O. Vol. 409  
C.T. Vol.

Fol. 399  
Fol.

Ward of Charuma  
County of Nariva  
Cadastral Sheet D.25.I

GN

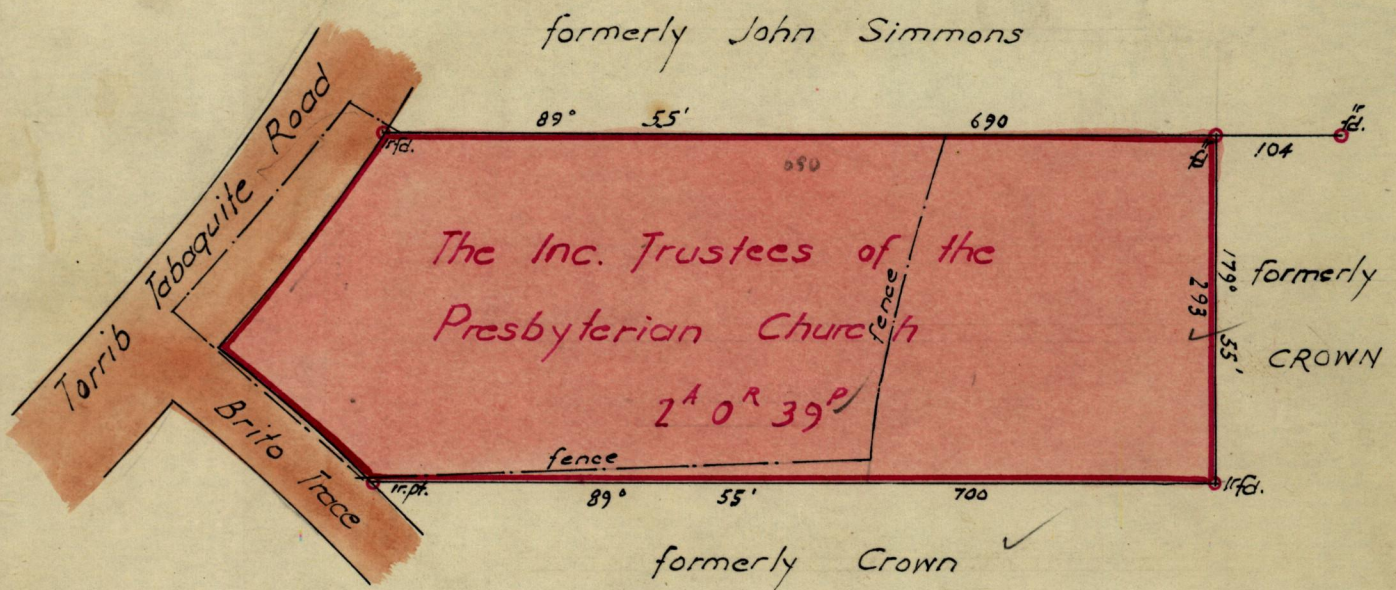

Approved

*[Signature]*

Director of Surveys

31.10.77

SCALE 1:1250

Note: To obtain compass bearings add/substract

minutes

Distances are in Lks

PLAN of a Parcel of land coloured pink in the Ward of Charuma

Containing Two acres and thirty nine perches

Surveyed by me, with due authority, in May 1977

I certify that I have complied with rule 76 under Section 14 (2) (d) of the Land Surveyors' Ordinance 1952, and that this plan is correct.

Checked by *[Signature]* 27/10/77

Land Surveyor, Trinidad

*[Signature]*

Entered.....

LANDS AND SURVEYS VAULT RECORDS



Original BK. 282:282.