

10153

L. & S.-54

463

Nº 37112

R.P.O. Vol. 144  
C.T. Vol.

Fol. 595  
Fol.

Ward of Siparia  
County of St. Patrick  
Cadastral Sheet G.18.H

G N

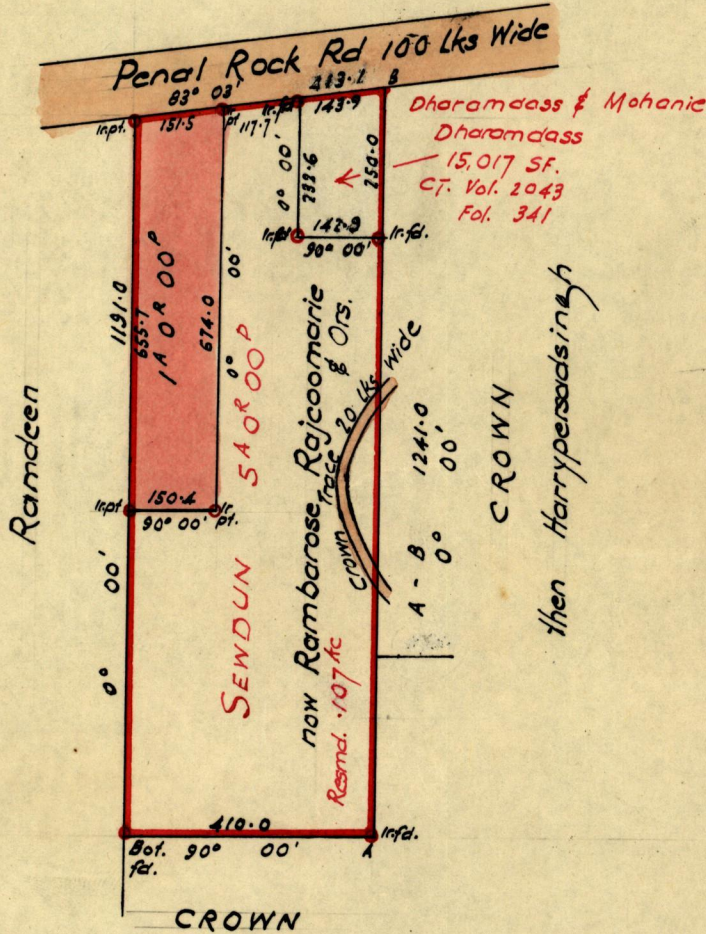

Approved

*John Samuel*  
24.2.77 Director of Surveys

SCALE 1:2500

Note: To obtain compass bearings add/subtract 0 minutes Distances are in L'ks.  
PLAN of a Parcel of land coloured pink in the Ward of Siparia  
Containing One acre

Surveyed by me, with due authority, in Oct. 1976

I certify that I have complied with rule 76 under Section 14 (2) (d) of the Land Surveyors' Ordinance 1952, and that this plan is correct.

Checked by *L.F.W 19/2/77*

*S. Allucharan*

Entered.....

Land Surveyor, Trinidad..... 20/11/1976.



Original Survey Bk. 397 fol 281

