

No 34918

1053

429

R.P.O. Vol. 578
C.T. Vol. 1150
2112

Fol. 1
Fol. 335
241

Ward of Diego Martin
County of St. George
Cadastral Sheet A.14.P.

Cyril Van Buren La Croix

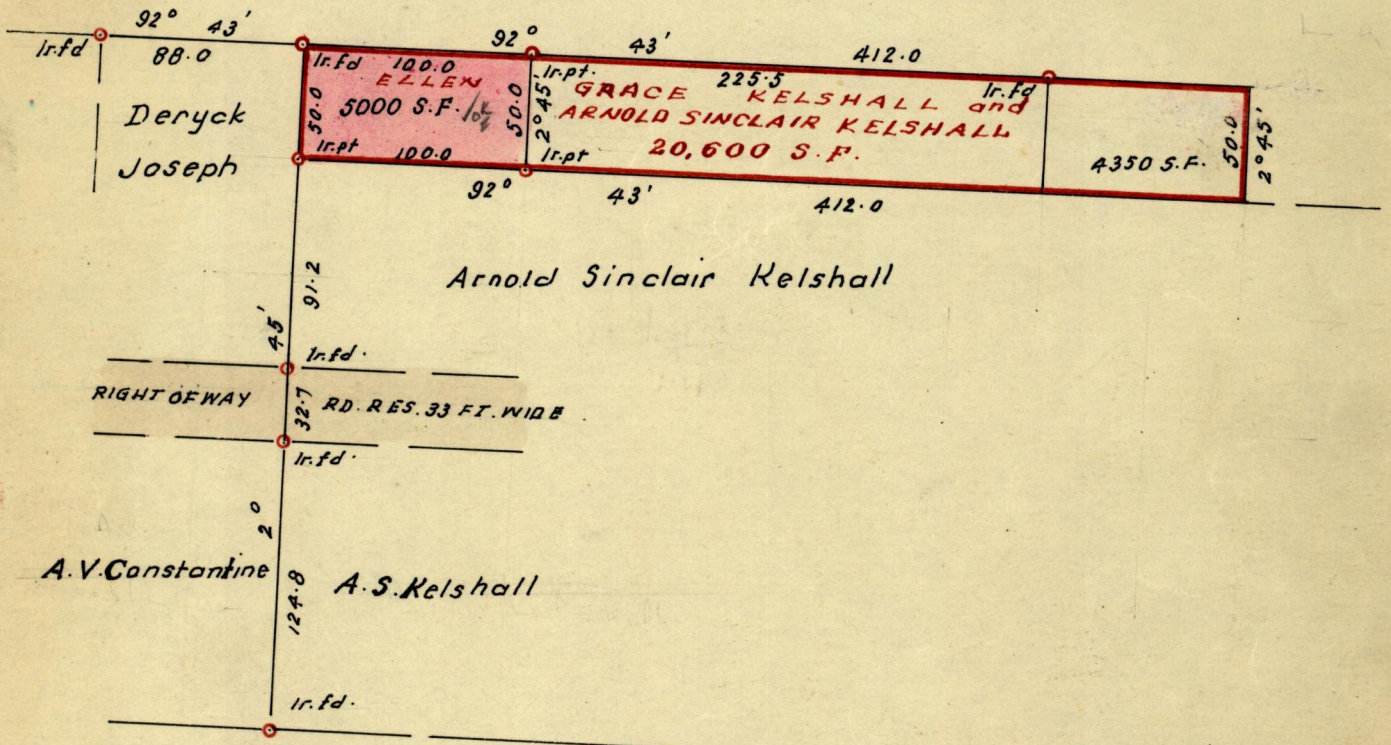

Cyril Van Buren La Croix

Approved

[Signature]
29.11.76 Director of Surveys

SCALE ~ 1:1000

Note: To obtain compass bearings ~~add~~/subtract 4 minutes Distances are in feet.

PLAN of a Parcel of land coloured pink in the Ward of Diego Martin
Containing five thousand square feet

Surveyed by me, with due authority, in October 1976

I certify that I have complied with rule 76 under Section 14 (2) (d) of the Land
Surveyors' Ordinance 1952, and that this plan is correct.

Checked by *[Signature]* 26/11/76

[Signature]
Land Surveyor, Trinidad 5th November 1976

Entered

Original Survey Plan R.B. 68.

1053

110 31013

West of
County of
Columbia, S.C.

111

110 31013

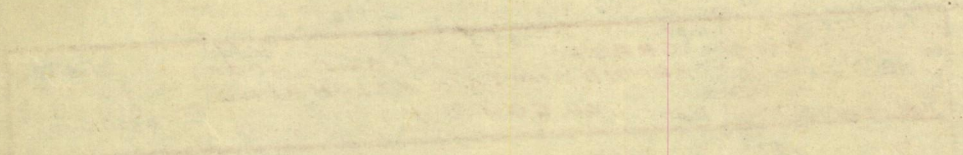

2011 B
Distance into the
of the land of

Approved
Survey of
This is a true and correct copy of the original survey plan as shown to me by the surveyor and the parties to the same, and I certify that it is a true and correct copy of the original survey plan as shown to me by the surveyor and the parties to the same.