

10153

L. & S.—54

425

No 38378

R.P.O. Vol. 130  
C.T. Vol.

Fol. 587  
Fol.

Ward of Naparima  
County of Victoria  
Cadastral Sheet G. 14, A & B

GN

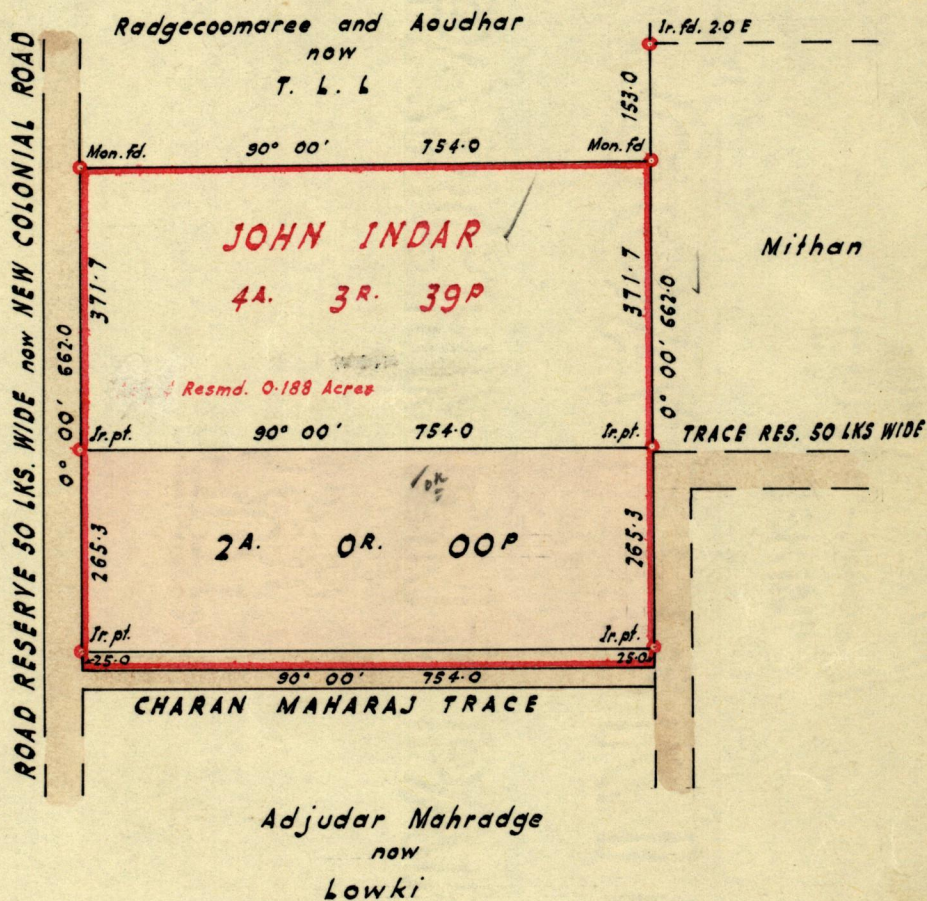

397

Approved

*Debab Samant*  
19.11.76. Director of Surveys

SCALE - 1 : 2000

Note: To obtain compass bearings add/subtract - minutes Distances are in Links

PLAN of a Parcel of land coloured Pink in the Ward of Naparima

Containing Two Acres

Surveyed by me, with due authority, in September 1976

I certify that I have complied with rule 76 under Section 14 (2) (d) of the Land Surveyors' Ordinance 1952, and that this plan is correct.

Checked by *LFW 26/11/76*

*Balkecharan*

Entered.....

Land Surveyor, Trinidad..... 25/10/1976.

2

Original bk. 397 fol. 110

