

No 38230

R.P.O. Vol. 215
C.T. Vol. 736

Fol. 449
Fol. 283

Ward of Siparia
County of St Patrick
Cadastral Sheet G.B.J

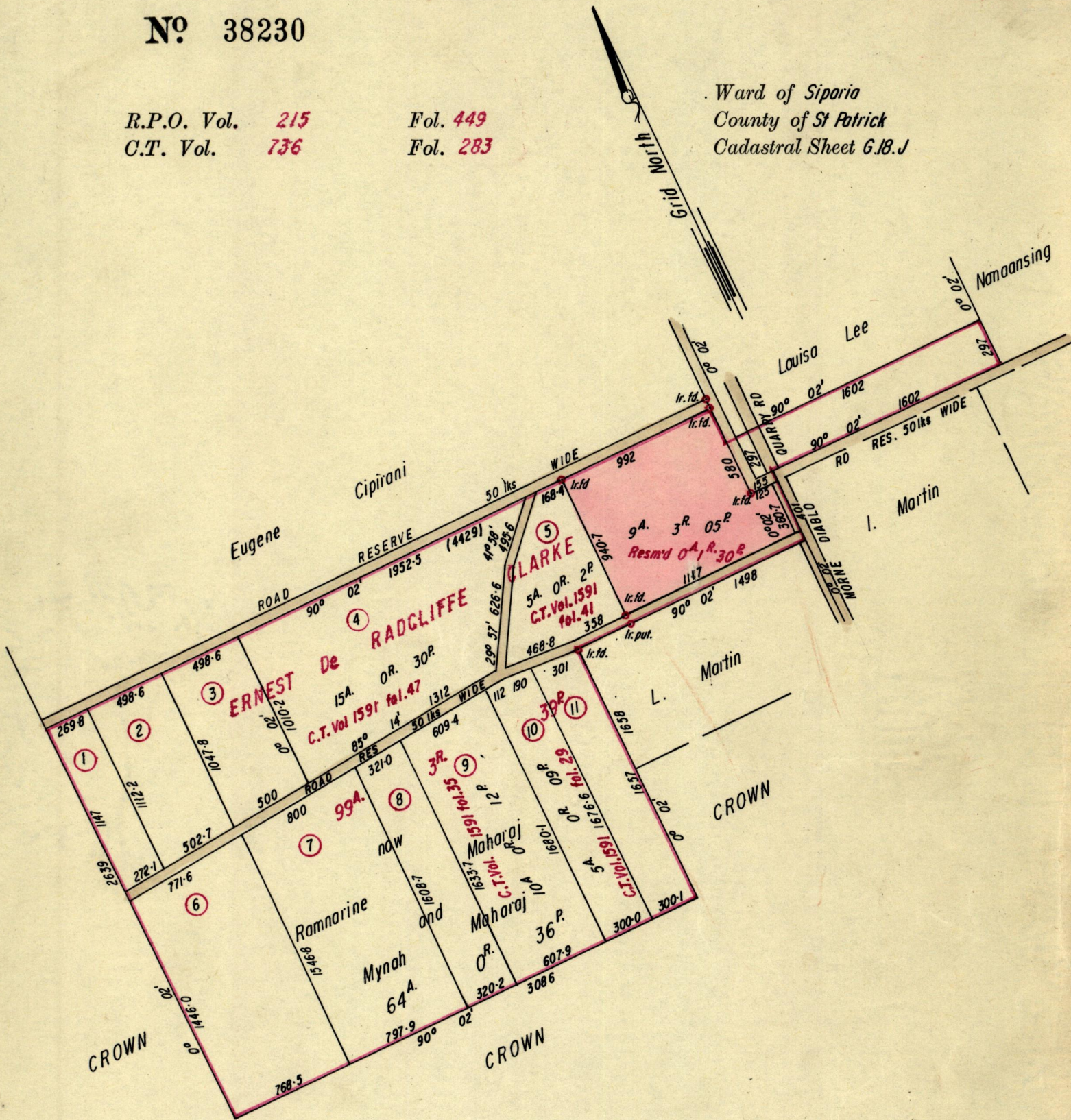

Approved

Geoffrey Samuel
Director of Surveys

23.9.76.

SCALE 8 chains to 1 Inch

minutes Distances are in links

Note: To obtain compass bearings add/subtract
PLAN of a Parcel of land coloured pink
Containing nine acres three roads and five perches
Surveyed by me, with due authority, in

in the Ward of Siparia

I certify that I have complied with rule 76 under Section 14 (2) (d) of the Land Surveyors' Ordinance 1952, and that this plan is correct.

Checked by *L.F.W. 22/9/76*

J. Maharaj. J.L.S.
Land Surveyor, Trinidad. 20th Sept 1976

Entered.....

Original Survey R. B. 18.

See Bk 999 A1 110