

Nº 13848

1053

R.P.O. Vol. 4.
C.T. Vol.

Fol 485.
Fol

Ward of Turure
County of St Andrew.
Cadastral Sheet E. I. H.

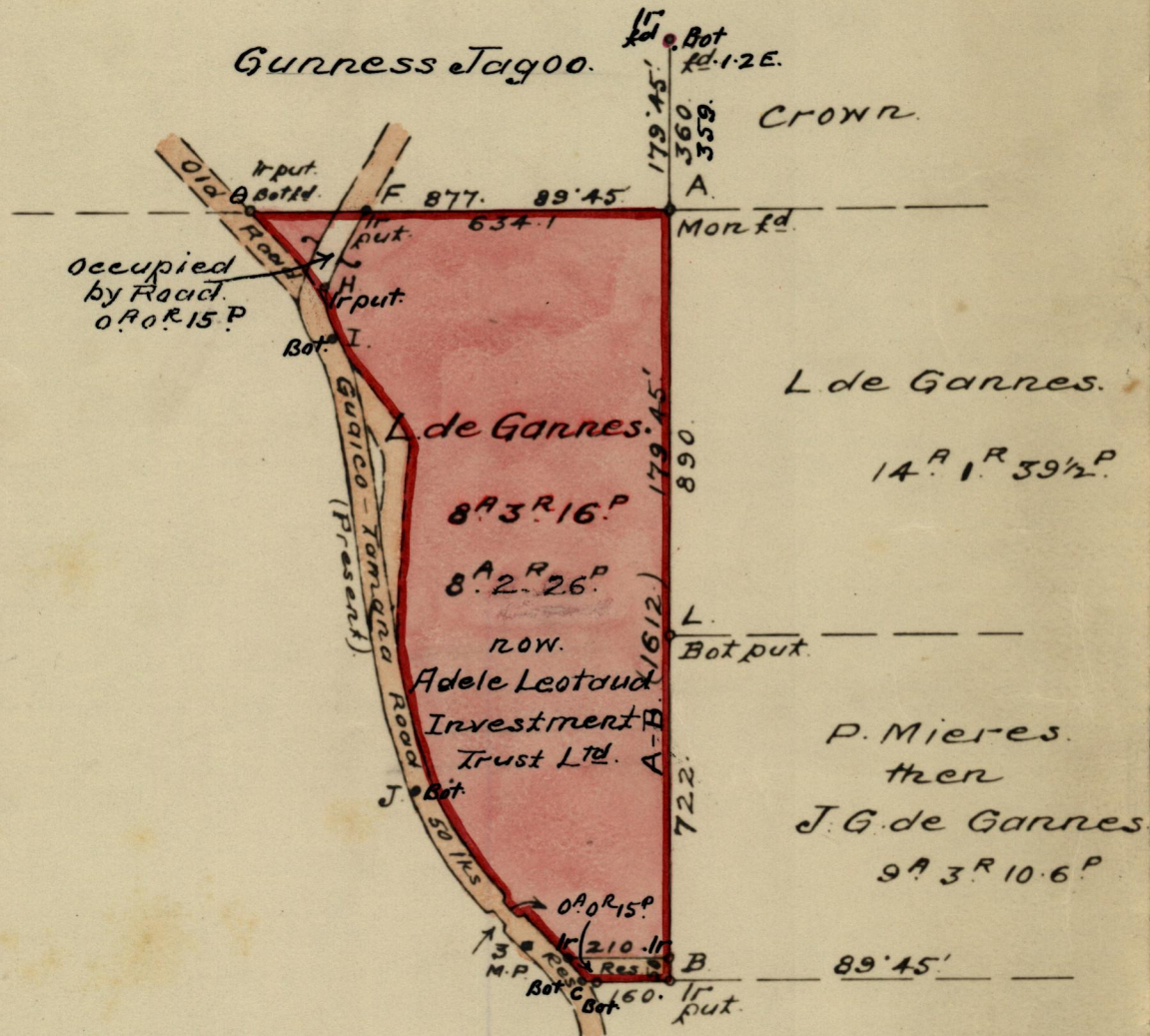

Approved

Fred E. Farrell

Director of Surveys
9. 6. 65

Note: To obtain compass bearings add/subtract + 15'

SCALE 4 Chains = 1" inch
minutes Distances are in links.

PLAN of a Parcel of land coloured pink in the Ward of Turure.
Containing eight acres two roods & twenty-six perches.
Surveyed by me, with due authority, in Feb 1964.

I certify that I have complied with rule 76 under Section 14 (2) (d) of the Land Surveyors' Ordinance 1952, and that this plan is correct.

Checked by *[Signature]* 15/3/65

[Signature]
Land Surveyor, Trinidad 1964

Orig Survey Bk 166 fol 37

1023