

No 25034

R.P.O. Vol. 106
C.T. Vol. 652

Fol. 113
Fol. 125

Ward of La Brea
County of St. Patrick
Cadastral Sheet F.15 J.E.K.

G. N.

This is the plan referred to as marked "A" in the prefixed Memo of Transfer dated the 2nd day of August, 1974. and made by Alberting Haynes in favour of Joseph Holloway and Florence Marchant.

John Cameron
Conveyancer.

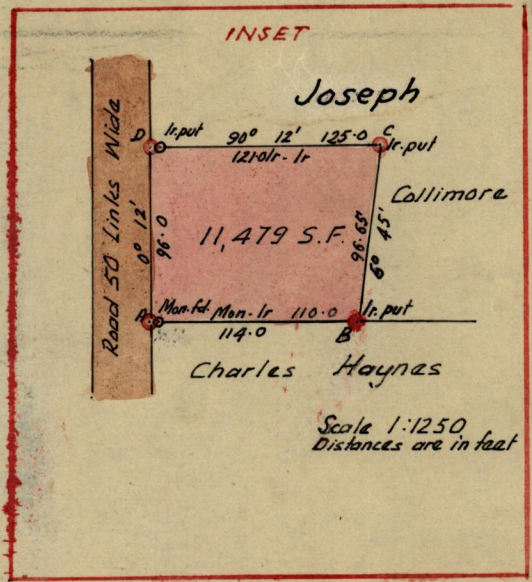
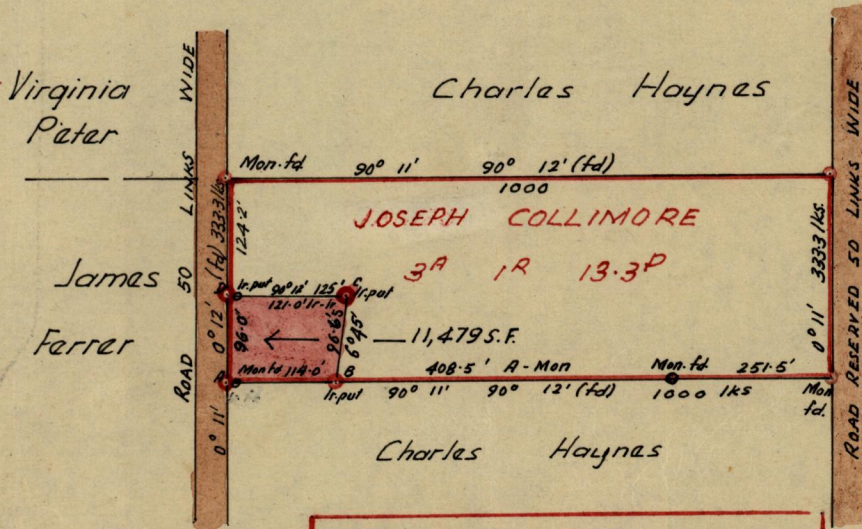

Approved

John Cameron
Director of Surveys
24.4.75

SCALE 1:2500

Note: To obtain compass bearings ~~add~~/subtract 12 minutes Distances are in Links & feet

PLAN of a Parcel of land coloured pink in the Ward of La Brea
Containing Eleven thousand four hundred and seventy-nine square feet
Surveyed by me, with due authority, in June 1968

I certify that I have complied with rule 76 under Section 14 (2) (d) of the Land Surveyors' Ordinance 1952, and that this plan is correct.

Checked by *L. J. D. 24/4/75*

Kannon Richard

Entered

Land Surveyor, Trinidad 12th December 1968.

