

Nº 26688

1053

R.P.O. Vol. 12
C.T. Vol. 751

Fol. 77
Fol. 147

Ward of Naparima
County of VICTORIA
Cadastral Sheet G.9,M

64A
3/0; 3/19

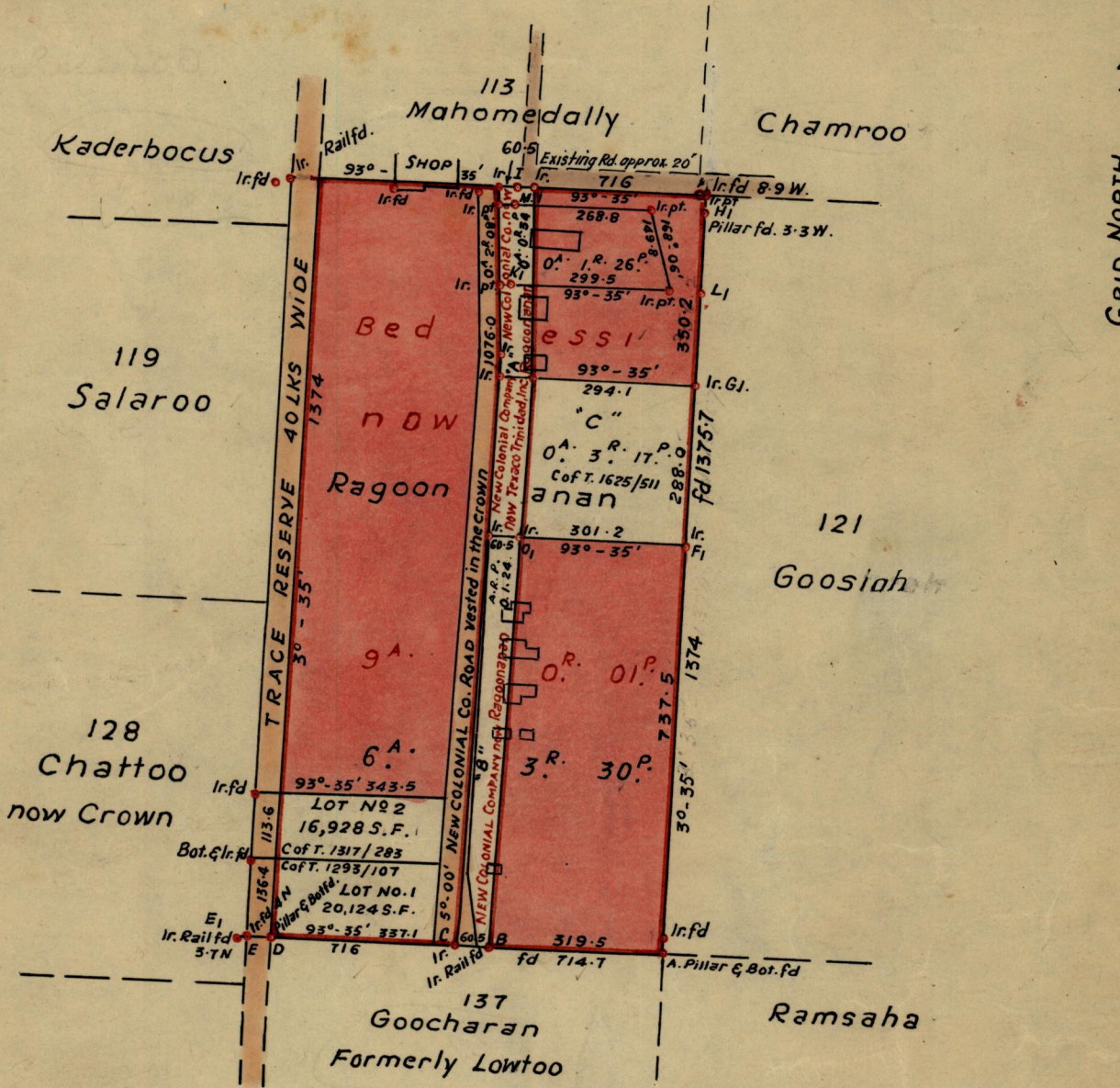

Approved

[Signature]
 Director of Surveys
 23.3.66

SCALE 1 : 2500

Note : To obtain compass bearings add/subtract 0 minutes Distances are in Links
 PLAN of a Parcel of land coloured pink in the Ward of Naparima
 Containing six acres, three roods and thirty perches.
 Surveyed by me, with due authority, in March, 1961 for Ragoonanan.
 I certify that I have complied with rule 76 under Section 14 (2) (d) of the Land
 Surveyors' Ordinance 1952, and that this plan is correct.

Checked by *[Signature]* 23/3/66

Entered

Land Surveyor, Trinidad *[Signature]* 3rd December 1966

No. 26883

Word of
County of
Catahoula

Vol.
Vol.

Page
Page

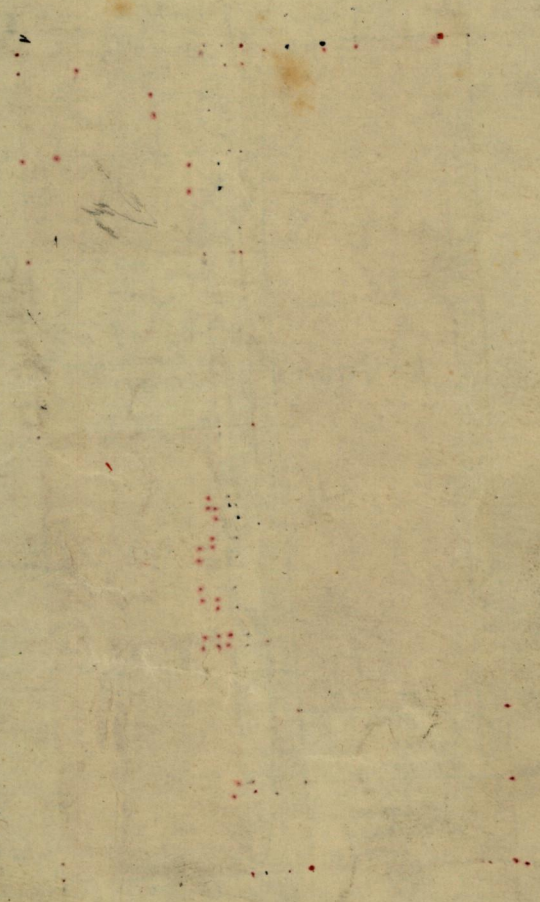

Approved

Director of Lands

SCOTT

Deputy

Note: To obtain complete history of land

PLAT of a Parcel of land colored

Containing

Surveyed by

A certain tract of land colored in the

Surveyors' Commission 1852, and which is covered

Created by

Land Surveyor, Titled

OFFICE OF THE DIRECTOR OF LANDS