

1053

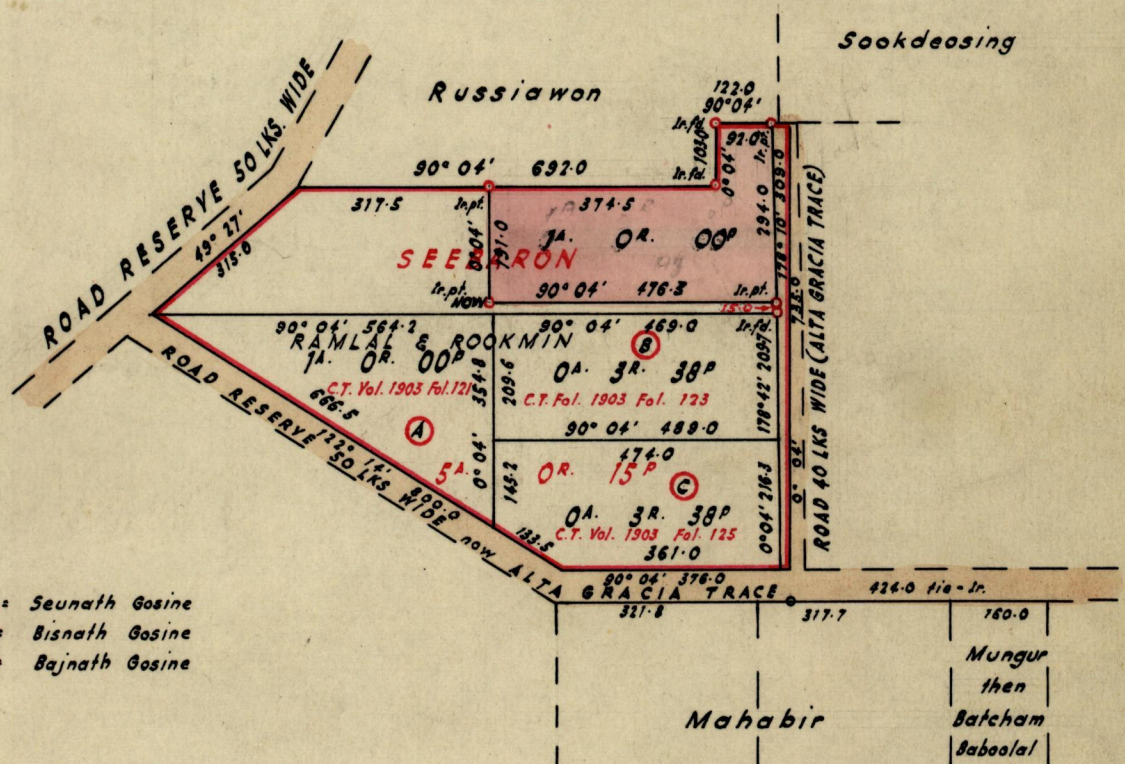

- (A) = Seunath Gosine
- (B) = Bisnath Gosine
- (C) = Bajnath Gosine

Approved P. J. W. 3/2/75
 Director of Surveys
 5.2.75.

SCALE - 1:2500

Note: To obtain compass bearings subtract 4 minutes

Distances are in Links

PLAN of a Parcel of land coloured Pink in the Ward of Siparia
 Containing One Acre

Surveyed by me, with due authority, in April 1974.

I certify that I have complied with rule 76 under Section 14 (2) (d) of the
 Land Surveyors' Ordinance 1952, and that this plan is correct.

Checked by P. J. W. 3/2/75

P. B. Charan
 Land Surveyor, Trinidad 20th May 1974.

LANDS AND SURVEYS VAULT RECORDS

Original bk. 980 fol. 125