

No 32283

1053

296

C.J. Vol 1032  
R.P.O. Vol. 51

Fol. 441  
Fol. 599

Ward of La Brea  
County of St. Patrick  
Cadastral Sheet F.15.F

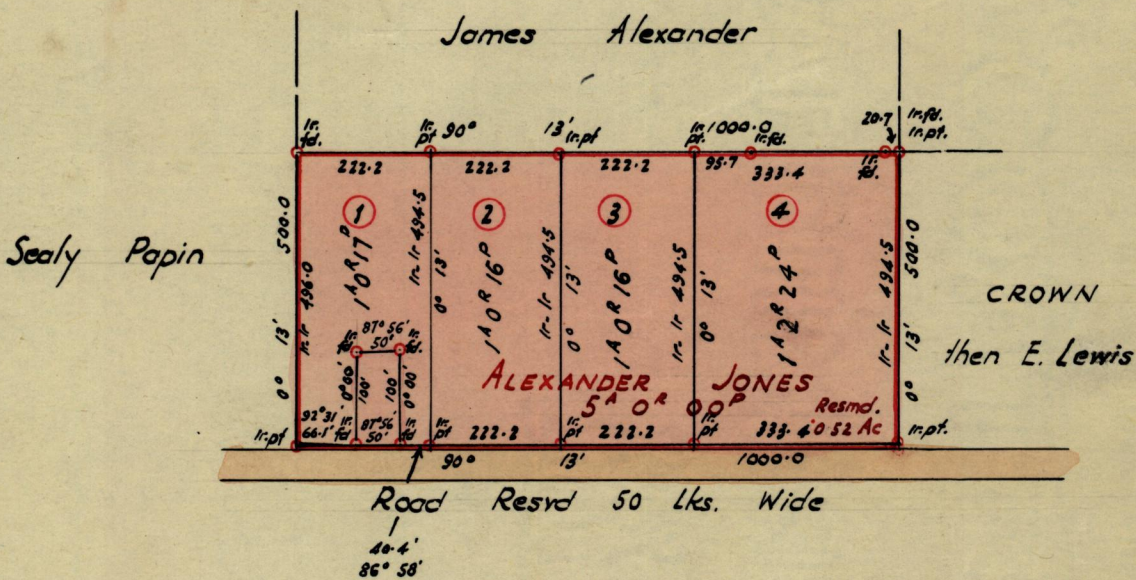

Approved  
*[Signature]*  
27.12.74 Director of Surveys

SCALE 1:2500

Note: To obtain compass bearings add/subtract 13 minutes Distances are in Lks & Ft.

PLAN of 4 Parcels of land coloured pink in the Ward of La Brea  
Containing together Four acres three roods and thirty three perches  
Surveyed by me, with due authority, in March 1972

I certify that I have complied with rule 76 under Section 14 (2) (d) of the Land Surveyors' Ordinance 1952, and that this plan is correct.

Checked by *[Signature]* 24/12/74

*[Signature]*

Entered .....

Land Surveyor, Trinidad 30<sup>th</sup> April 1974

Original Survey / Bk. 461 fol 229