

1053

273

L. and S.—53

No 58120

Cadastral Sheet G.12.P

C.T. Vol. 473 Fol. 403

Ward of Siparia

R.P.O. Vol. 58 Fol. 81

County of St. Patrick

G N

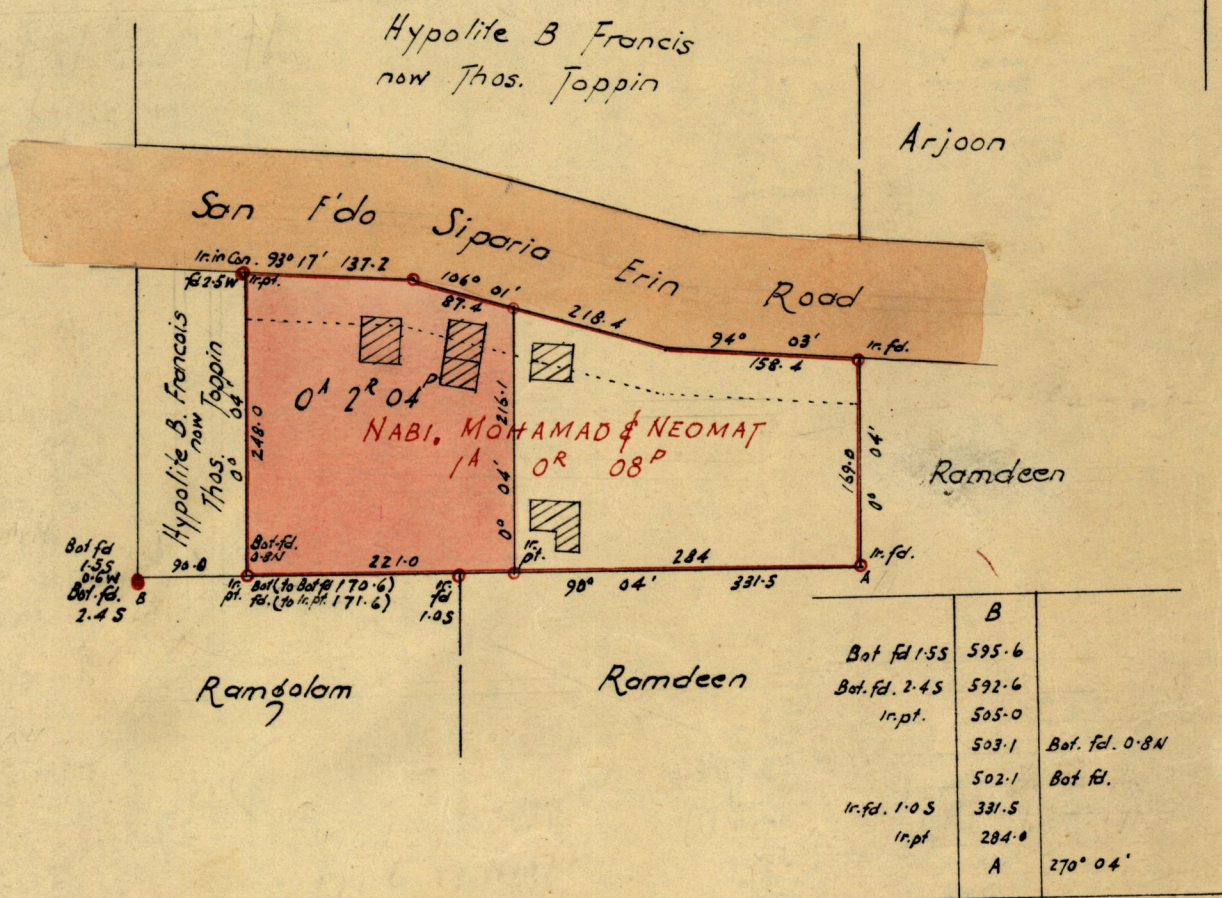

Approved *[Signature]*
 Director of Surveys
 26.6.74

SCALE 1:1250

Note: To obtain compass bearing subtract 4 minutes Distances are in Lks

PLAN of a Parcel of land coloured pink in the Ward of Siparia
 Containing Two roads and four perches
 Surveyed by me, with the authority, in March 1974 for
 I certify that I have complied with Rule 76 under Sec. 14 (2)(d) of the Land Surveyors'
 Ord. 1952, and that this plan is correct.

Checked by *[Signature]*
 Entd by *[Signature]*

Land Surveyor, Trinidad 25th May 1974

G.P., Tr./To.—2378—10,000—10/72

LANDS AND SURVEYS VAULT RECORDS

P.T. 10/473/403

C.L. STOUTE 2-prints

Original Survey BE 718 fol 220

Wabi, Mohamad
and Neomat
1-0-08

Arjoon

Randem

A R P
0-2-04

8/2/101