

City of Port of Spain

1053

County of St. George

Sheet A.20.O.

R.P.O. Vol 1621 Fol. 169

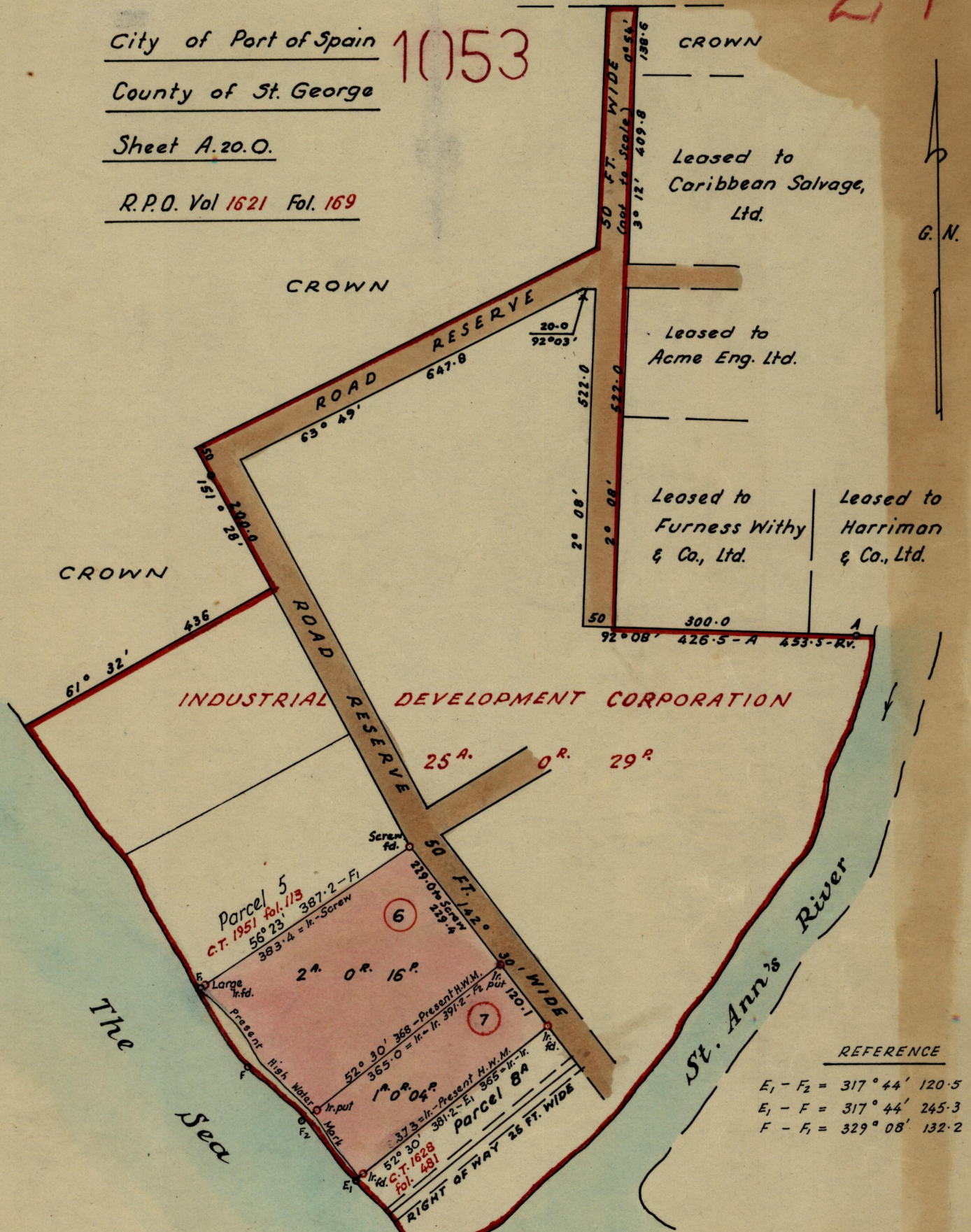

REFERENCE

E <sub>1</sub> - F <sub>2</sub>	= 317° 44' 120.5
E <sub>1</sub> - F	= 317° 44' 245.3
F - F <sub>1</sub>	= 329° 08' 132.2

Approved

*R. A. Farrell*

Director of Surveys.  
31.7.72

Scale : 1/2500  
Distances are in feet

Note: Bearings are based on Control Marks.

PLAN of 2 Parcels of Land coloured pink in the City of Port of Spain  
Surveyed by me, with due authority in July 1972.

I certify that I have complied with Rule 76 under Section 14(2)(d) of the  
Land Surveyors' Ordinance 1952, and that this plan is correct.

Checked by *L. J. W. 29/7/72*

Entered

*J. R. Gardiner*  
Land Surveyor, Trinidad. 21<sup>st</sup> July 1972



Orig. Survey Bk. 993 fol. 24

1053

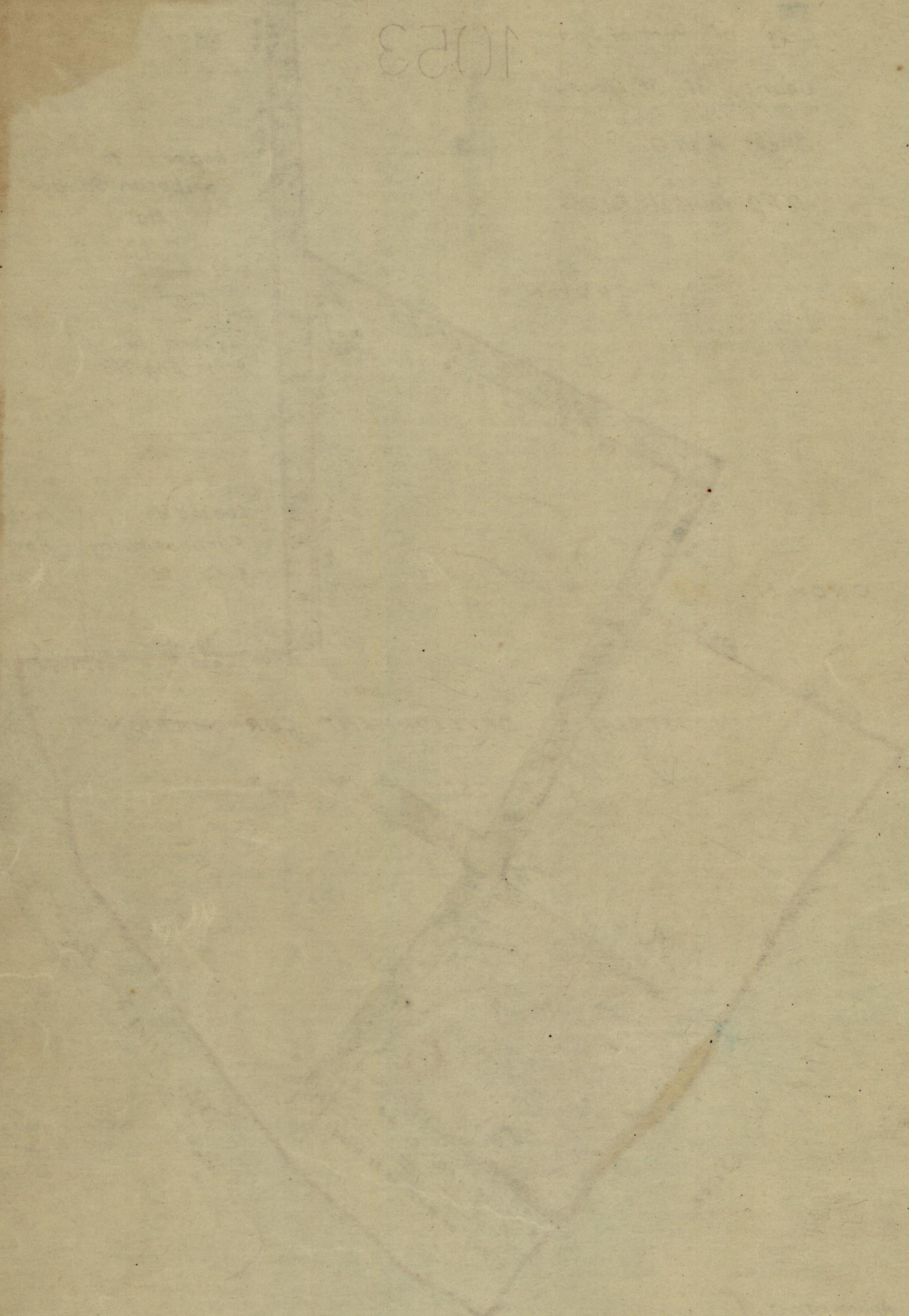

LAND AND FOREST SURVEY

BK 1053 fol 24