

No 34470

1053

21

R.P.O. Vol. 28
C.T. Vol. 1821

Fol. 237
Fol. 341

Ward of Naparima
County of Victoria
Cadastral Sheet G 8 N

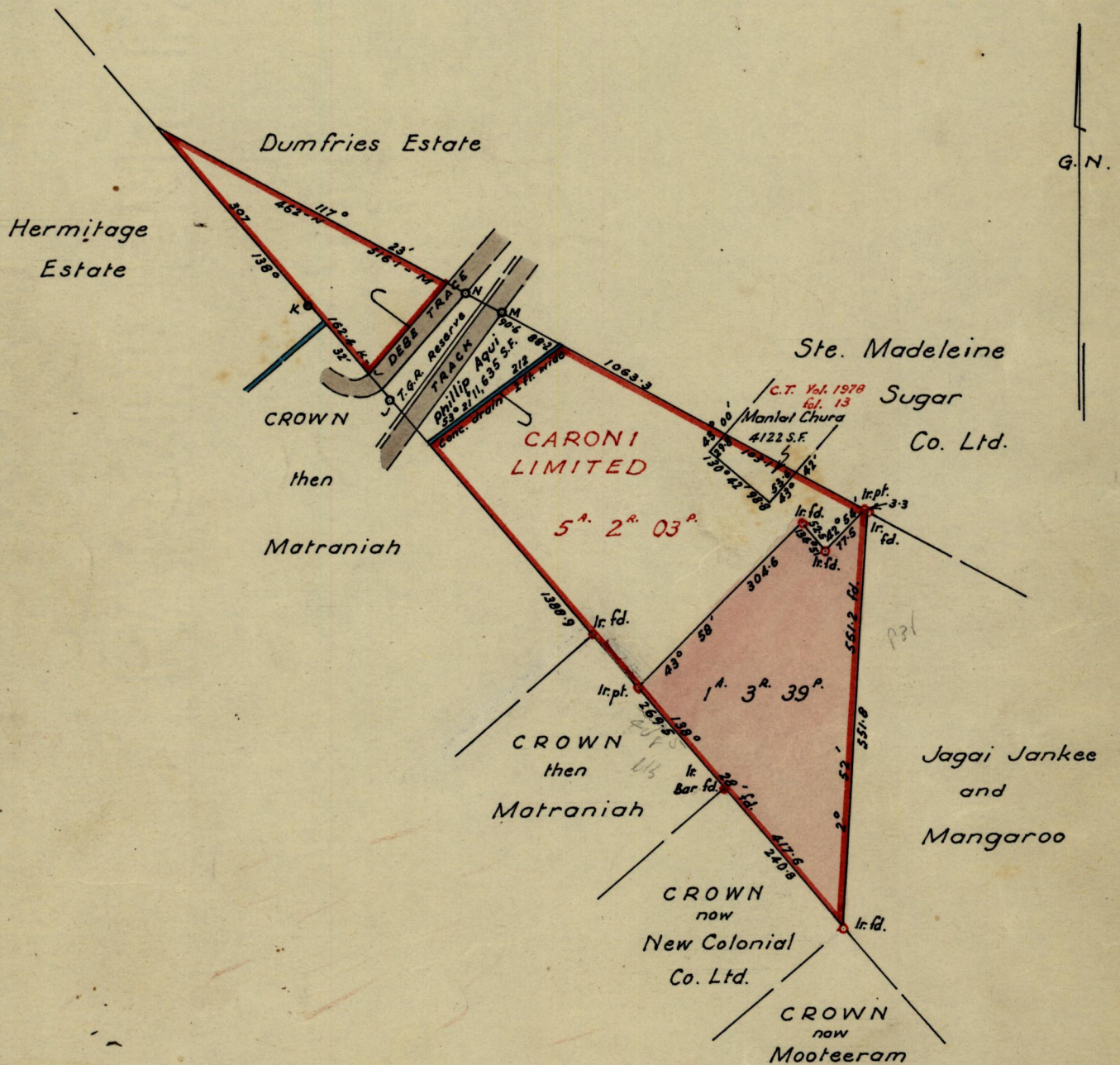

Approved

D. H. Fane

Director of Surveys
5. 3. 74

SCALE 1 : 2500

Note : To obtain compass bearings ~~add~~ subtract 2 minutes Distances are in feet

PLAN of a Parcel of land coloured pink in the Ward of Naparima
Containing one acre, three roods and thirty nine perches
Surveyed by me, with due authority, in June 1973

I certify that I have complied with rule 76 under Section 14 (2) (d) of the Land
Surveyors' Ordinance 1952, and that this plan is correct.

Checked by *L. J. W. 5/4/74*

G. R. Gardiner
Land Surveyor, Trinidad
4th Jan. 1974

Original bk 710 fol. 160

Ward of
County of
Catharine State

Fol.
Fol.

R.P.O. Vol.
C.T. Vol.

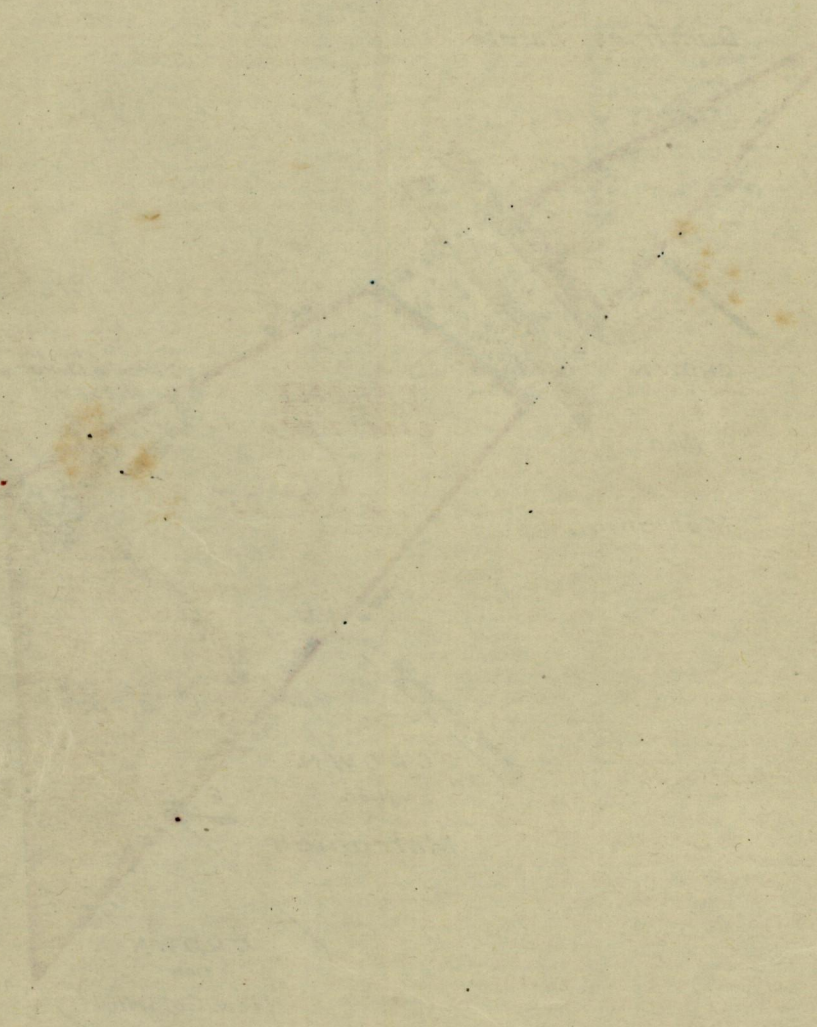

SCALE

Containing a plan of land colored in the Ward of

200 feet by 100 feet the entire area

1 acre (40 rods) (1/4 section 11 (S) of the land

containing 40 rods, and that this plan is correct

Witness my hand and seal this 1st day of

1860

Notary Public