

105

No 31316

1053

R.P.O. Vol 35
C.T. Vol. 517

Fol. 243
Fol. 325

Ward of Tamana
County of St. Andrew
Cadastral Sheet E 1 M

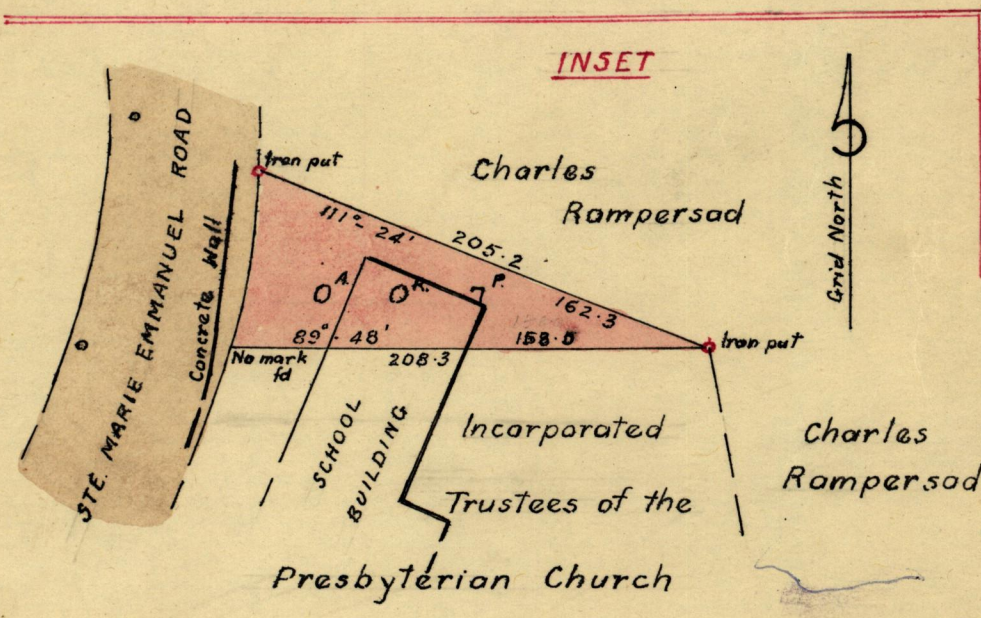
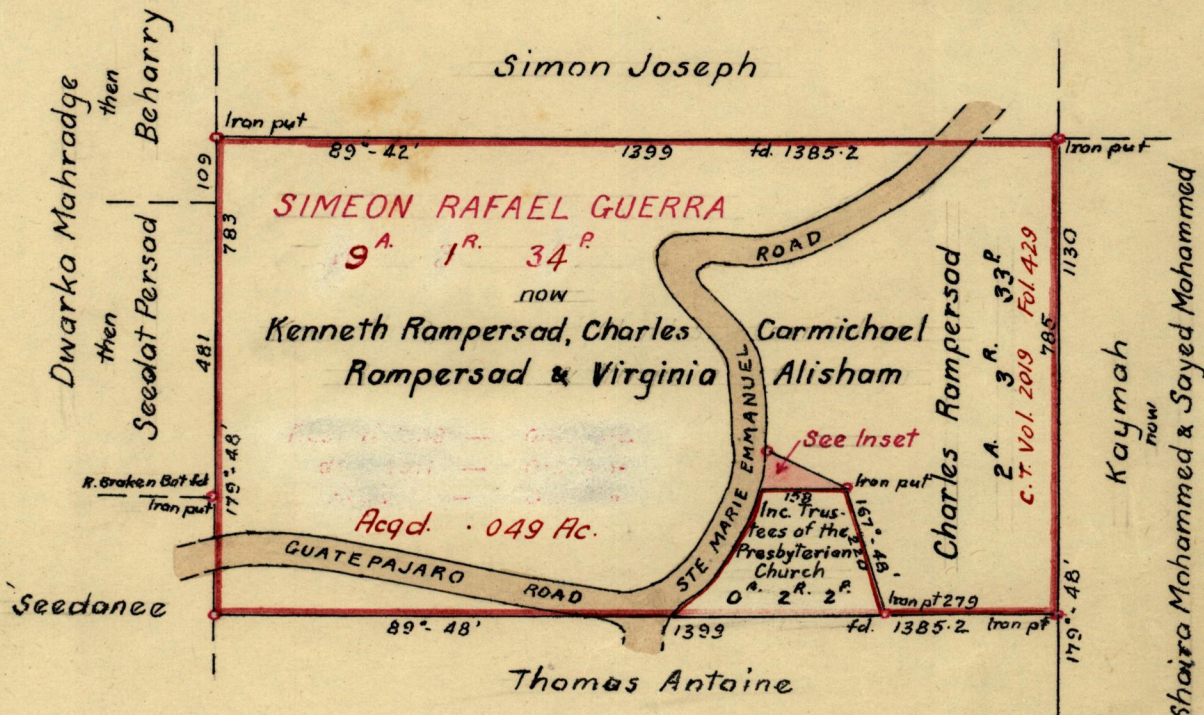

Approved

F. E. Farrell

Director of Surveys

22. 3. 73

SCALE : 1 — 500

Note : To obtain compass bearings add ~~12~~ 12 minutes Distances are in links

PLAN of a Parcel of land coloured pink in the Ward of Tamana
Containing seven perches

Surveyed by me, with due authority, in October 1971 for the Inc. Trustees of the Presbyterian Church.
I certify that I have complied with rule 76 under Section 14 (2) (d) of the Land Surveyors' Ordinance 1952, and that this plan is correct.

Checked by *F. E. Farrell* 21/3/73

F. E. Farrell

Entered

Land Surveyor, Trinidad 29th December 1971

Orig

Survey

Bk.

120 fol

45.

1053

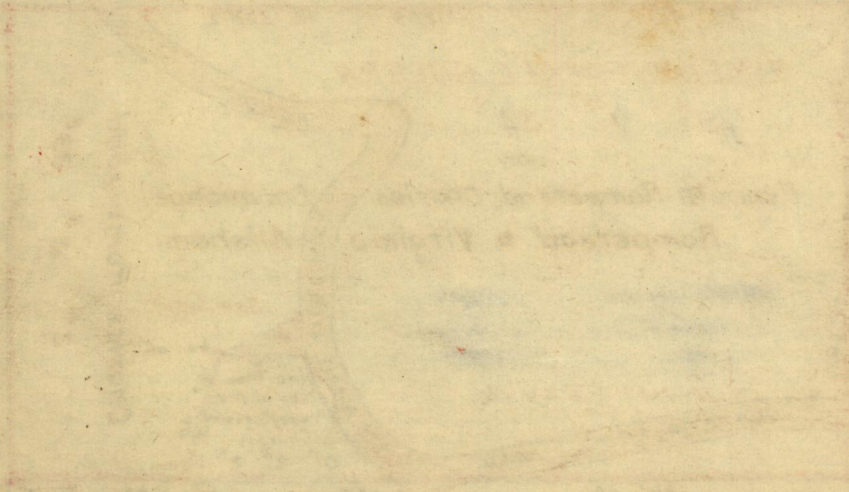

BR 1053:105