

Cadastral Sheet A.20.0, 23B, 13D&23A
1c
City of Port of Spain
County of St. George

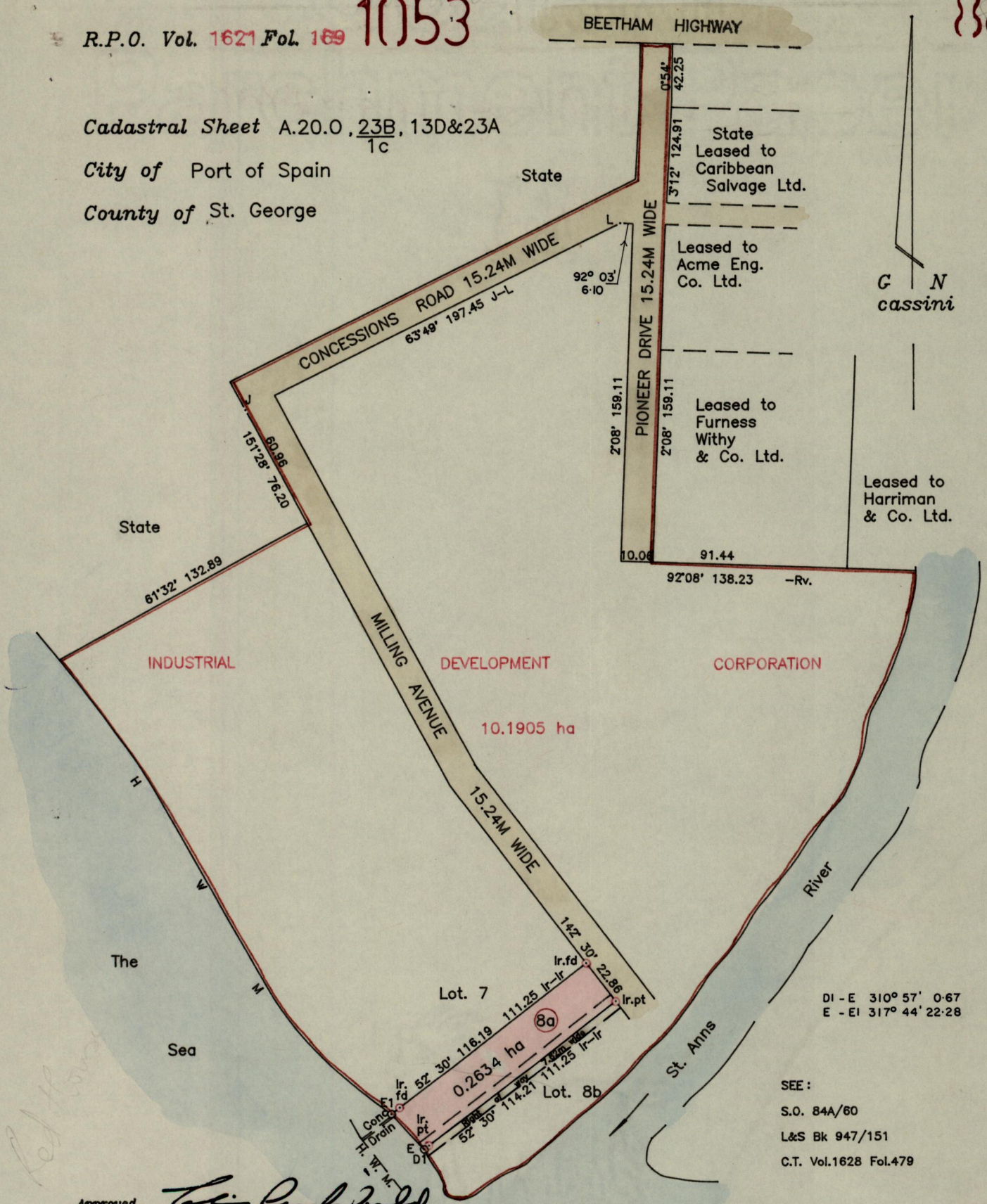

Approved

[Signature]
Director of Surveys
960520

SCALE 1/2500

Note: Bearings are based on solar observations.

Distances are in metres

PLAN of a Parcel of land coloured pink in the City of Port of Spain
Containing zero point two six three four hectares

Surveyed by me with due authority in September 1995

I certify that I have complied with rule 76 under section 14(2)(d) of the
Land Surveyors' Ordinance 1952, and that this plan is correct.

Checked by *[Signature]*
15/5/96

Entered on ----- Land Surveyor, Trinidad. *[Signature]* 15th November 1995

907.151