

INSET

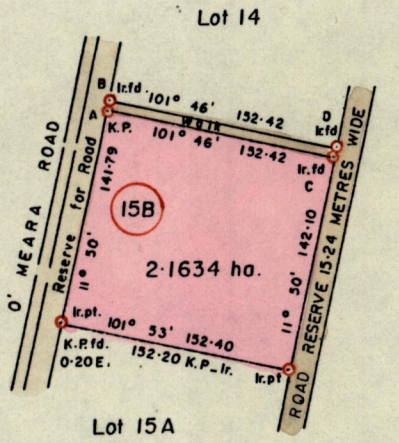

A-B 11° 34' 4.57
 C-D 11° 34' 4.57

SCALE : 1/5000
 Distances are in metres

C.T. Vol. 2384
 Fol. 233

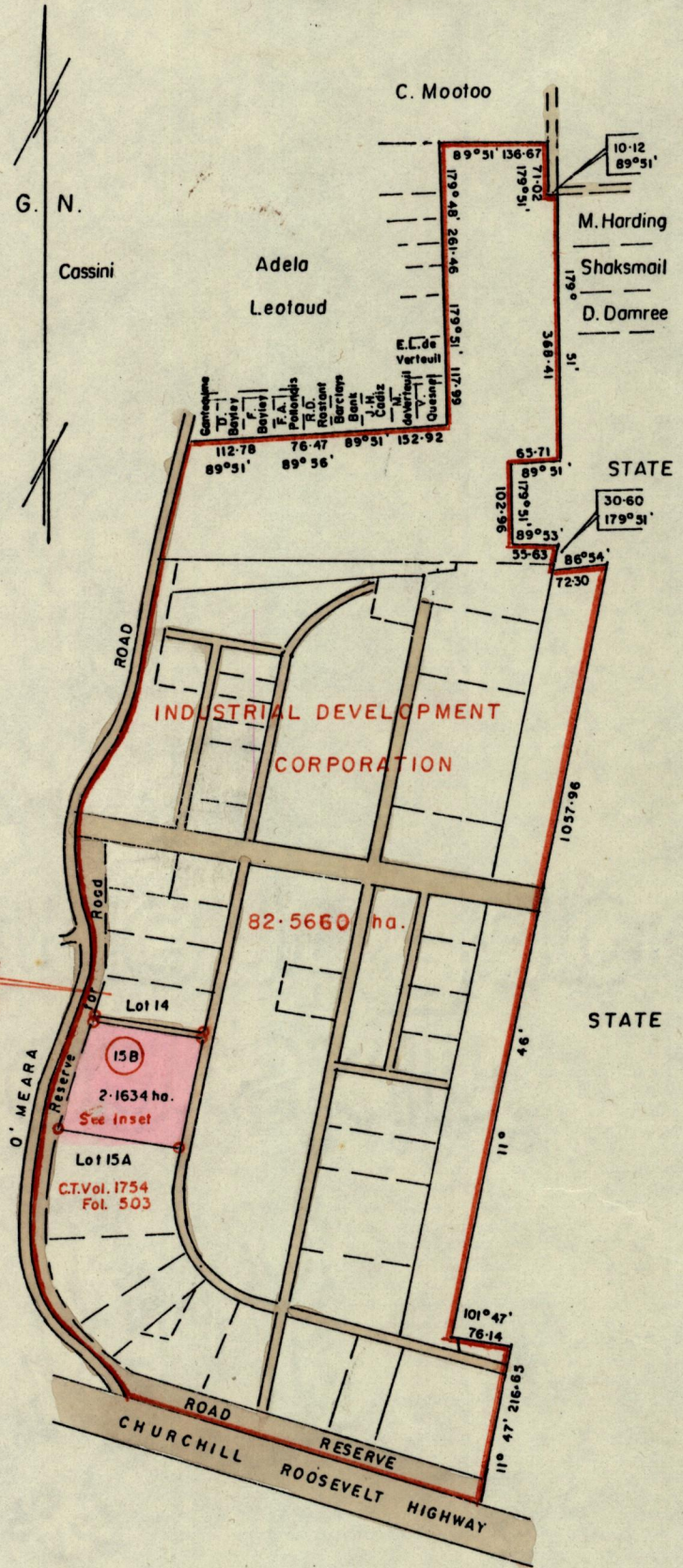

Approved *[Signature]*
 Land Control

Director of Surveys
 90.07.24

SCALE : 12chns = 1"
 Distances are in metres

To obtain compass bearings add 10 minutes

Plan of a parcel of land coloured pink in the Ward of Arima
 Containing two point one six three four hectares
 Surveyed by me, with due authority in November 1989

I certify that I have complied with Rule 76 under Section 14 (2) (d) of the Land Surveyors'

Ordinance 1952 and that this plan is correct.

Checked by *G. Rencorista*
 24/7/90

[Signature]

Entered _____

Land Surveyor, Trinidad 14th Dec. 1989