

1053

{ } ( ) ( )

No 17077

R.P.O. Vol. 223  
C.T. Vol.

Fol. 271  
Fol.

Ward of Turure  
County of St. Andrew  
Cadastral Sheet E.12.F. (45C/2/a)

REFERENCE

A-A <sub>0</sub>	341° 16'	26.35	} See S.O.No. 1227/1908
A <sub>0</sub> -A <sub>1</sub>	336° 46'	50.09	
A <sub>1</sub> -B	330° 16'	12.87	
Along Cen. Line of Cunapo S.Rd.			
α-β	11° 05'	32.83	
δ-α	151° 50'	53.31	

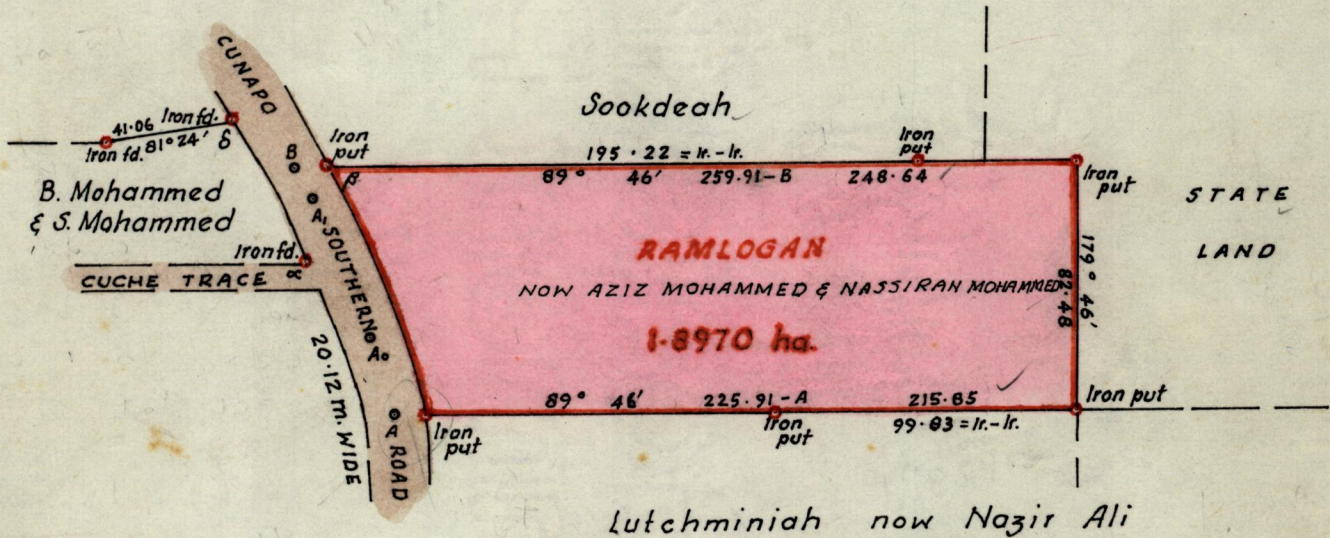
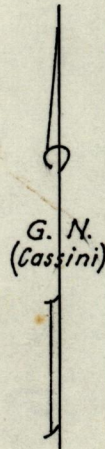

Approved

*[Signature]*  
Director of Surveys  
88.05.12

SCALE: 1/2500

Note: To obtain compass bearings add ~~to the~~ 14 minutes Distances are in metres

PLAN of a Parcel of land coloured pink in the Ward of Turure  
Containing one point eight nine seven zero hectares  
Re-Surveyed by me, with due authority, in May 1987

I certify that I have complied with rule 76 under section 14(2)(d) of the  
Land Surveyors' Ordinance 1952, and that this plan is correct.

Checked by *[Signature]* 28/4/88

Entered ..... Land Surveyor, Trinidad *[Signature]* 27<sup>th</sup> May 1987