

No 18038

R.P.O. Vol. 432
C.T. Vol. 2607

Fol. 61
Fol. 139

Ward of Toco
County of St. David
Cadastral Sheet c5E

PETIT TROU VILLAGE

PLAN. L.B.22

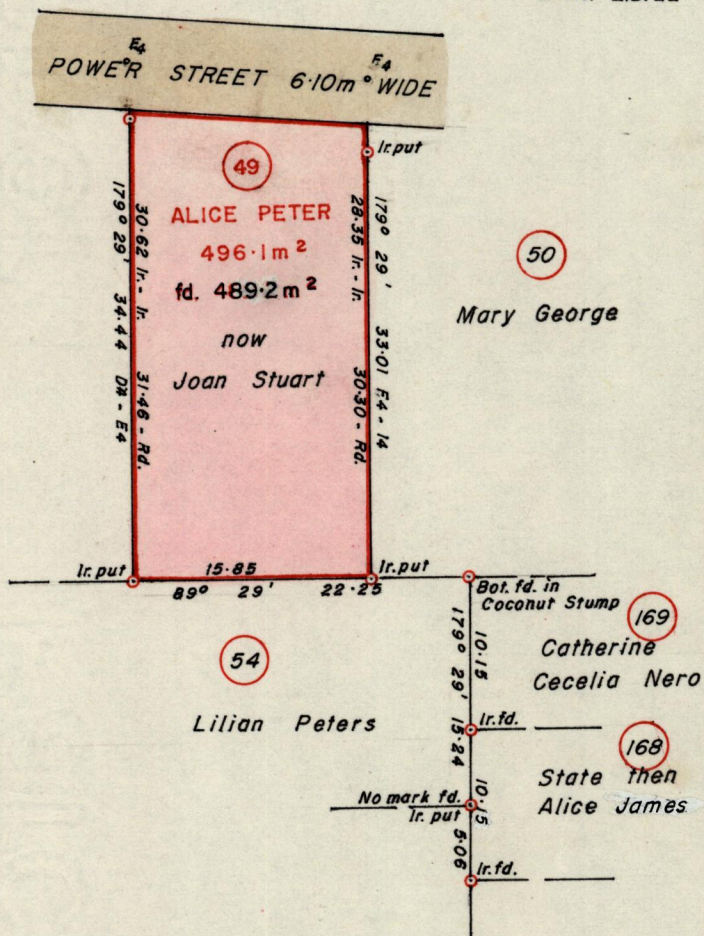

POWER STREET	W	6.10m WIDE
3.35	86.90	2.74
2.99	63.70	= E4
2.71	47.85	= F4
	31.70	= G4
2.44	30.48	3.66
	V	274° 19'

S.O. 22 / 54
F. B. N. Vol 52 Fol. 91

Approved *Alwyn H. Philip*
Director of Surveys
88.02.23

SCALE 1 - 500

Note: To obtain compass bearings add/subtract 31 minutes Distances are in Metres

PLAN of a Parcel of land coloured pink in the Ward of Toco
Containing four hundred and eighty nine point two square metres
Surveyed by me, with due authority, in January 1985

I certify that I have complied with rule 76 under section 14(2)(d) of the
Land Surveyors' Ordinance 1952, and that this plan is correct.

Checked by *[Signature]* 1/2/88
Entered Land Surveyor, Trinidad 26th Sept 1987