

C.T. Vol. 1415 Fol. 109
C.T. Vol. 2276 Fol. 121
General Plan Vol. 2272 Fol. 129

Ward of St. Anns
County of St. George
Cadastral Sheet 13F(B.17.B & F.)
3/a

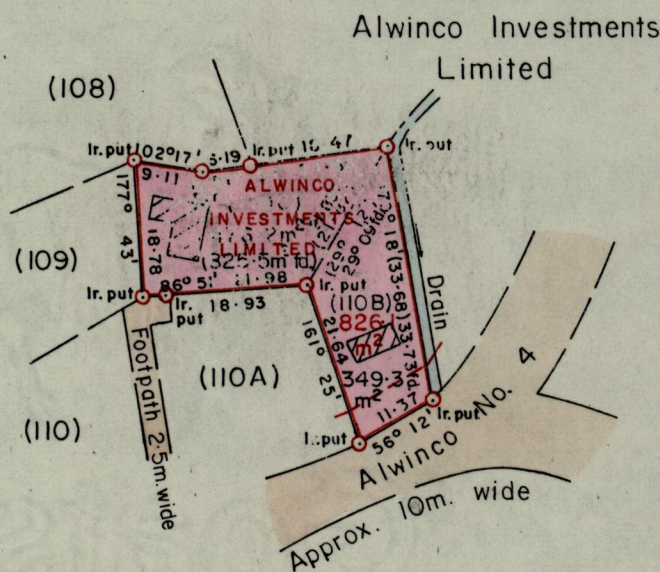
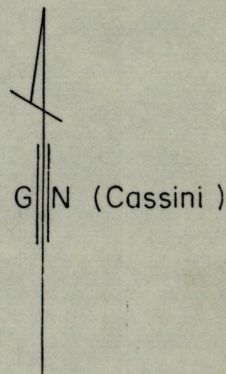

---Denotes building line 4.57m. from road.

Approved

H.B. Joseph
Director of Surveys
85-11-18

SCALE 1:1000

Distances are in METRES

Note: To obtain compass bearings add/subtract
minute
PLAN of 2 Parcelsof land coloured pink
Containing ^{together} eight hundred and twenty-five point five square metres.
Surveyed by me, with due authority, in May and September 1975.

I certify that I have complied with rule 76 under Section 14 (2) (d) of the Land Surveyors' Ordinance 1952, and that this plan is correct.

Checked by *J.D.* 85-11-18
Entered.....

Paul Williams
Land Surveyor, Trinidad1.1...|...1.2...|...19.84