

No 13426

C.T. Vol. 1415 Fol. 109
C.T. Vol. 2276 Fol. 103
General Plan Vol. 2272 Fol. 129

Ward of St. Anns
County of St. George
Cadastral Sheet 13F (B.17.B.&F.)
3/a

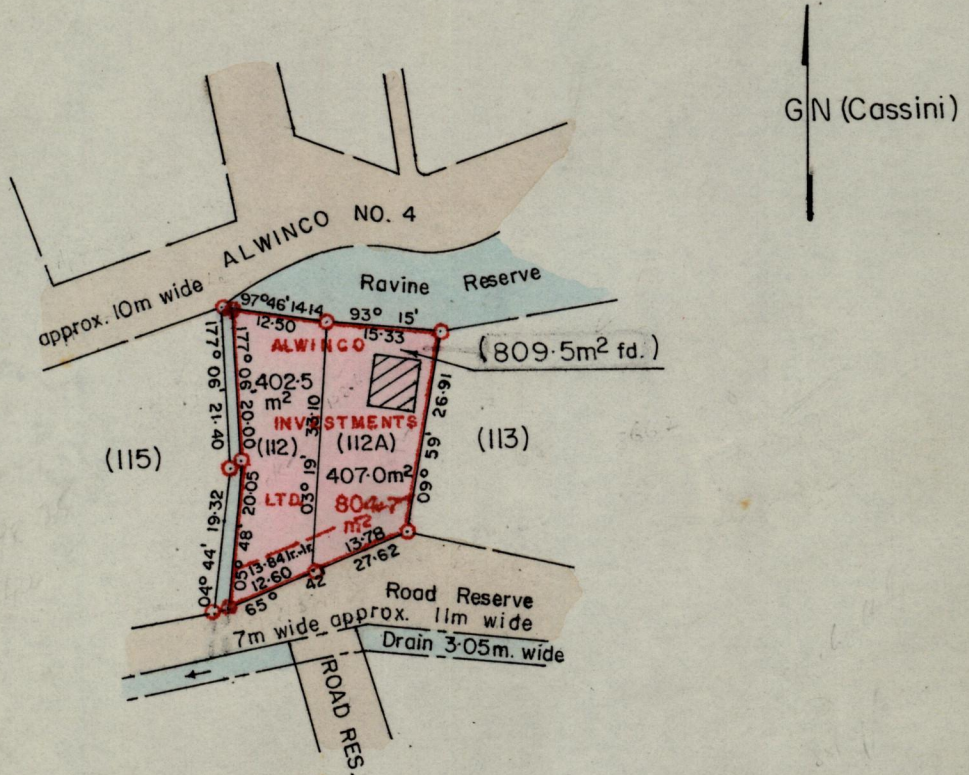

- Denotes Iron put
- Denotes building line 4.57m. from road.

Approved

K.B. Joseph
Director of Surveys
8.5.11.18

SCALE 1:1000

Note: To obtain compass bearings add/subtract 1 minutes Distances are in METRES.
PLAN of 2 Parcel of land coloured pink in the Ward of St. Anns.
Containing together eight hundred and nine point five square metres.
Surveyed by me, with due authority, in May and September 1975.
I certify that I have complied with rule 76 under section 14(2)(d) of the
Land Surveyors' Ordinance 1952, and that this plan is correct.

Checked by *J.S.S. 11.18* *Paul W. Williams*

Entered Land Surveyor, Trinidad *P.B. [illegible]* 1984