

No 10475

R.P.O. Vol. 593  
C.T. Vol. 1475

Fol. 249  
Fol. 135

Ward of Siparia  
County of St. Patrick  
Cadastral Sheet G14.M

Cassini  
G.N.

64D  
3/c

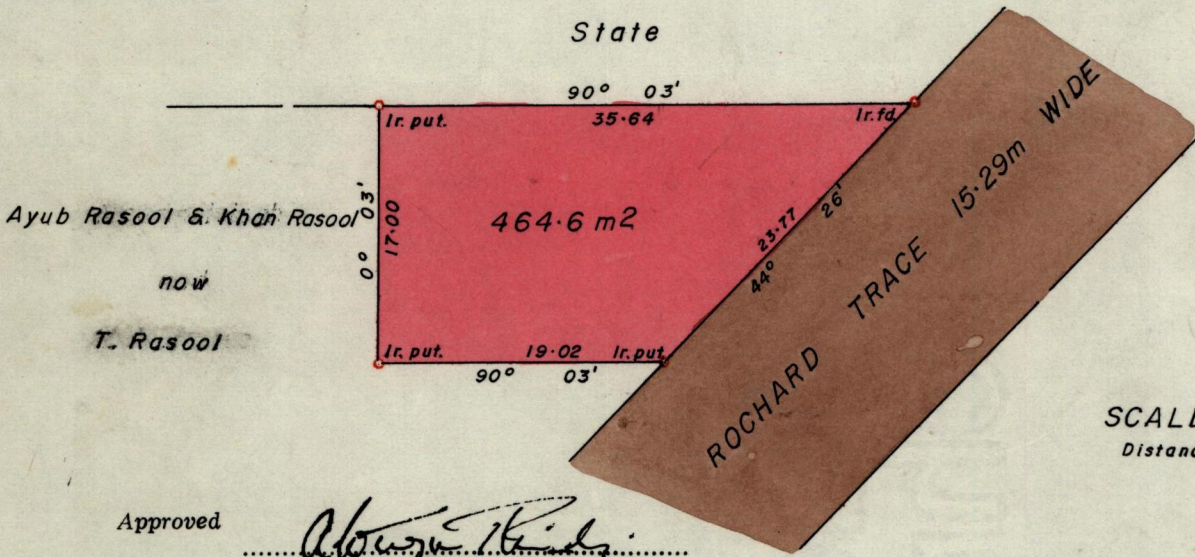
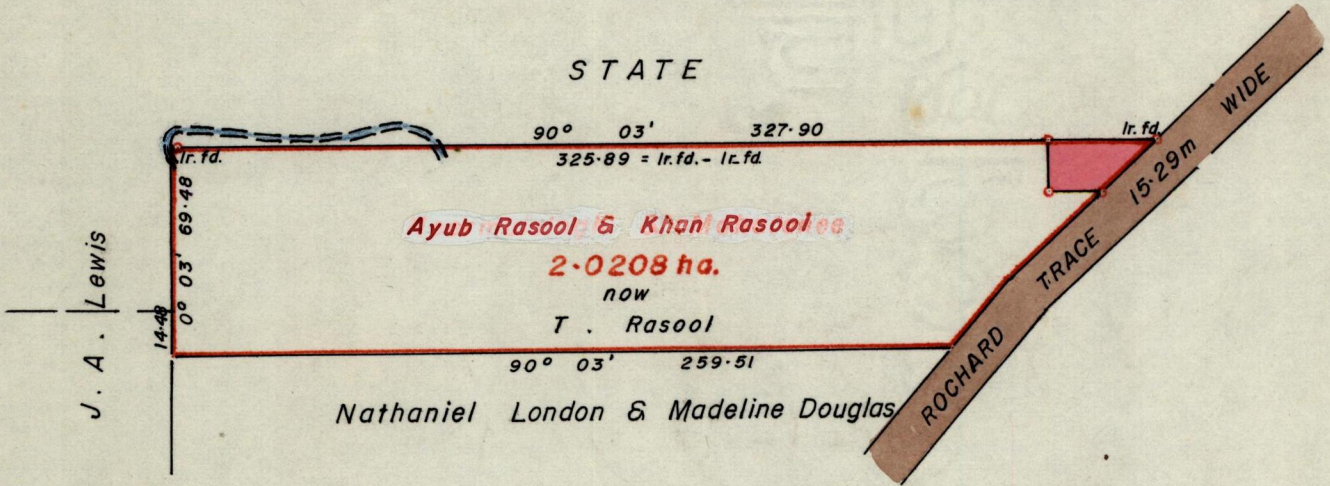

SCALE ~ 1 : 500  
Distances are in Metres

Approved

*Alwyn Kandy*  
Director of Surveys  
41 88.09.12

SCALE 1 : 2500

Note: To obtain compass bearings add/subtract 3 minutes Distances are in metres

PLAN of a Parcel of land coloured pink in the Ward of Siparia  
Containing four hundred and sixty-four point six square metres.  
Surveyed by me, with due authority, in December 1986  
I certify that I have complied with rule 76 under section 14(2)(d) of the  
Land Surveyors' Ordinance 1952, and that this plan is correct.

Checked by *[Signature]* 17/1/88 *Winston Ramnarain*

Entered *[Signature]* Land Surveyor, Trinidad 1st July 1987