

R.P.O. Vol 654
C.T. Vol. 2444

Fol. 535
Fol. 123

Ward of Siparia
County of St. Patrick
Cadastral Sheet G.13.L.

Survey Order No 138/28

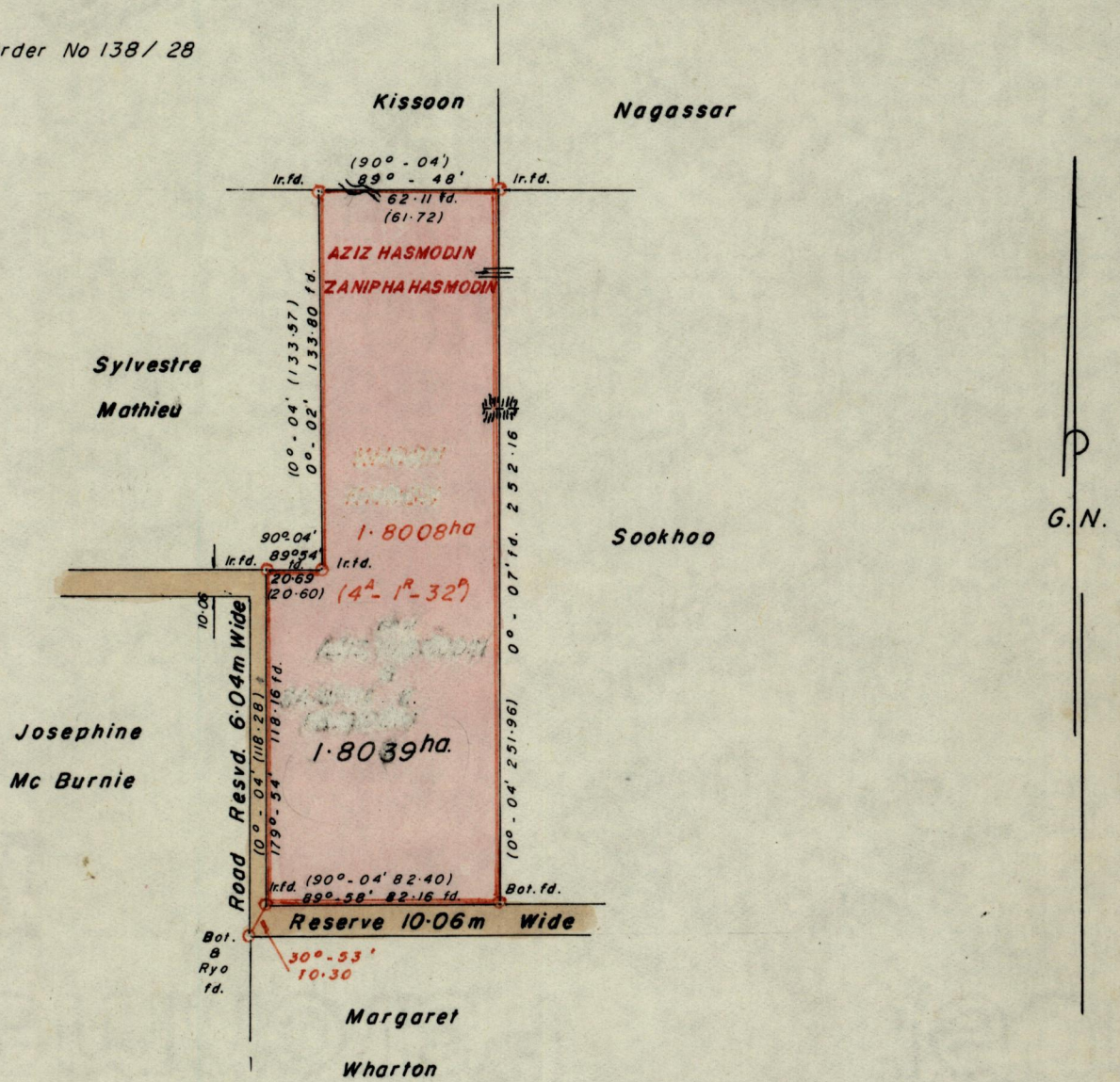

Approved

K.B. Joseph
Director of Surveys
85.1.15

Book 621 Fol 152

SCALE 1/2500

Note: To obtain compass bearings add/subtract minutes Distances are in Metres

PLAN of a Parcel of land coloured pink in the Ward of Siparia.

Containing One point eight zero three nine hectares.

Surveyed by me, with due authority, on 11th March 1982.

I certify that I have complied with rule 76 under section 14(2)(d) of the Land Surveyors' Ordinance 1952, and that this plan is correct.

Checked by *J.A. 85.1.15*

[Signature]
Land Surveyor, Trinidad 21. 1985

Entered