

No 1584

R.P.O. Vol. 70  
C.T. Vol. 2590

Fol. 33  
Fol. 479

Ward of SIPARIA  
County of ST. PATRICK  
Cadastral Sheet G11 L

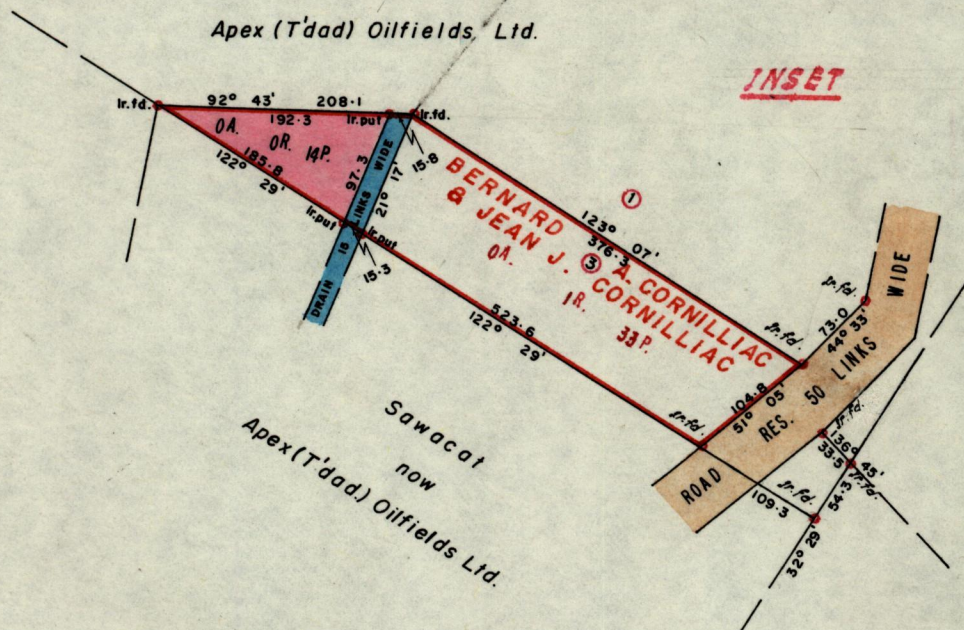
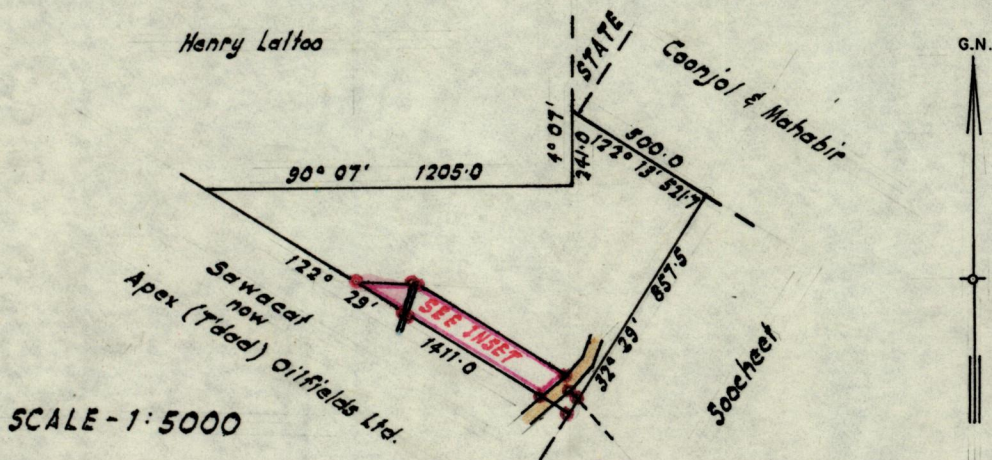

Approved *[Signature]*  
 Director of Surveys  
 8.2.04.19.

SCALE 1:1250

Note: To obtain compass bearings ~~add~~ subtract 7 minutes Distances are in links

PLAN of a Parcel of land coloured Pink in the Ward of SIPARIA  
Containing FOURTEEN Perches

Surveyed by me, with due authority, in July 1981

I certify that I have complied with rule 76 under section 14(2)(d) of the  
Land Surveyors' Ordinance 1952, and that this plan is correct.

Checked by *[Signature]* 82/04/14

Entered ..... Land Surveyor, Trinidad 18<sup>th</sup> August 1981.