

No 35450

R.P.O. Vol. 260
C.T. Vol.

Fol. 537
Fol.

Ward of Siparia
County of St. Patrick
Cadastral Sheet G. 14. M.

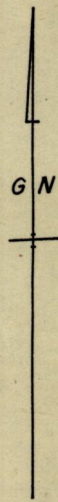

INSET

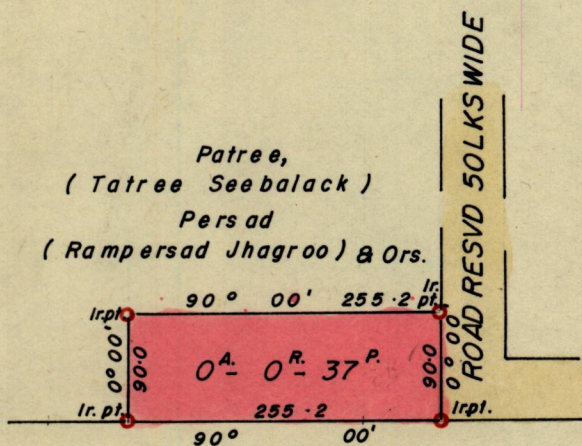

Pet. of Seetah

SCALE 1:1250
Distances are in Links.

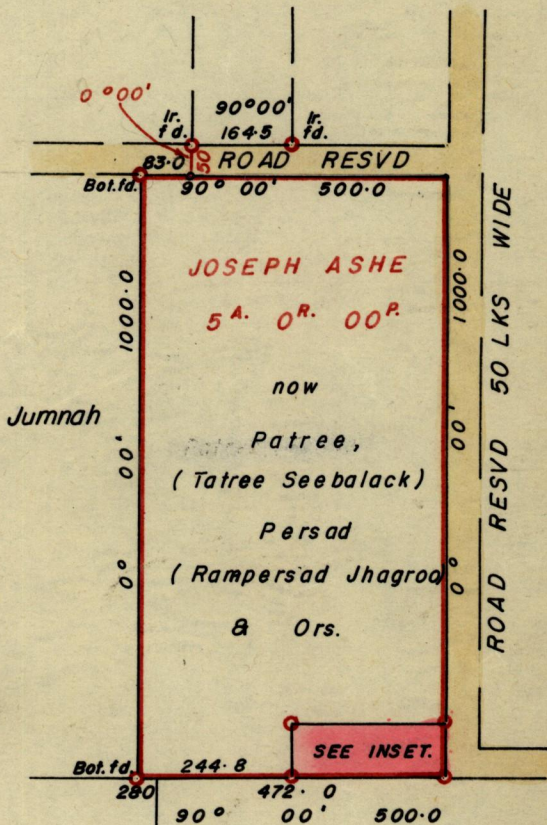

Pet. of Seetah

Approved *[Signature]*
Director of Surveys

SCALE 1:2500
Distances are in Lks.

Note: To obtain compass bearings add/subtract 0 minutes

PLAN of a Parcel of land coloured pink in the Ward of Siparia
Containing thirty seven perches.

Surveyed by me, with due authority, in Feb. 1981.

I certify that I have complied with rule 76 under Section 14 (2) (d) of the Land Surveyors' Ordinance 1952, and that this plan is correct.

Checked by *P. Beard 29/1/82*

[Signature]

Entered

Land Surveyor, Trinidad *3/4/* 1981