

No 2056

R.P.O. Vol. 151  
C.T. Vol. 1837

Fol. 5  
Fol. 499

Ward of Siparia  
County of St. Patrick  
Cadastral Sheet G.18. G.

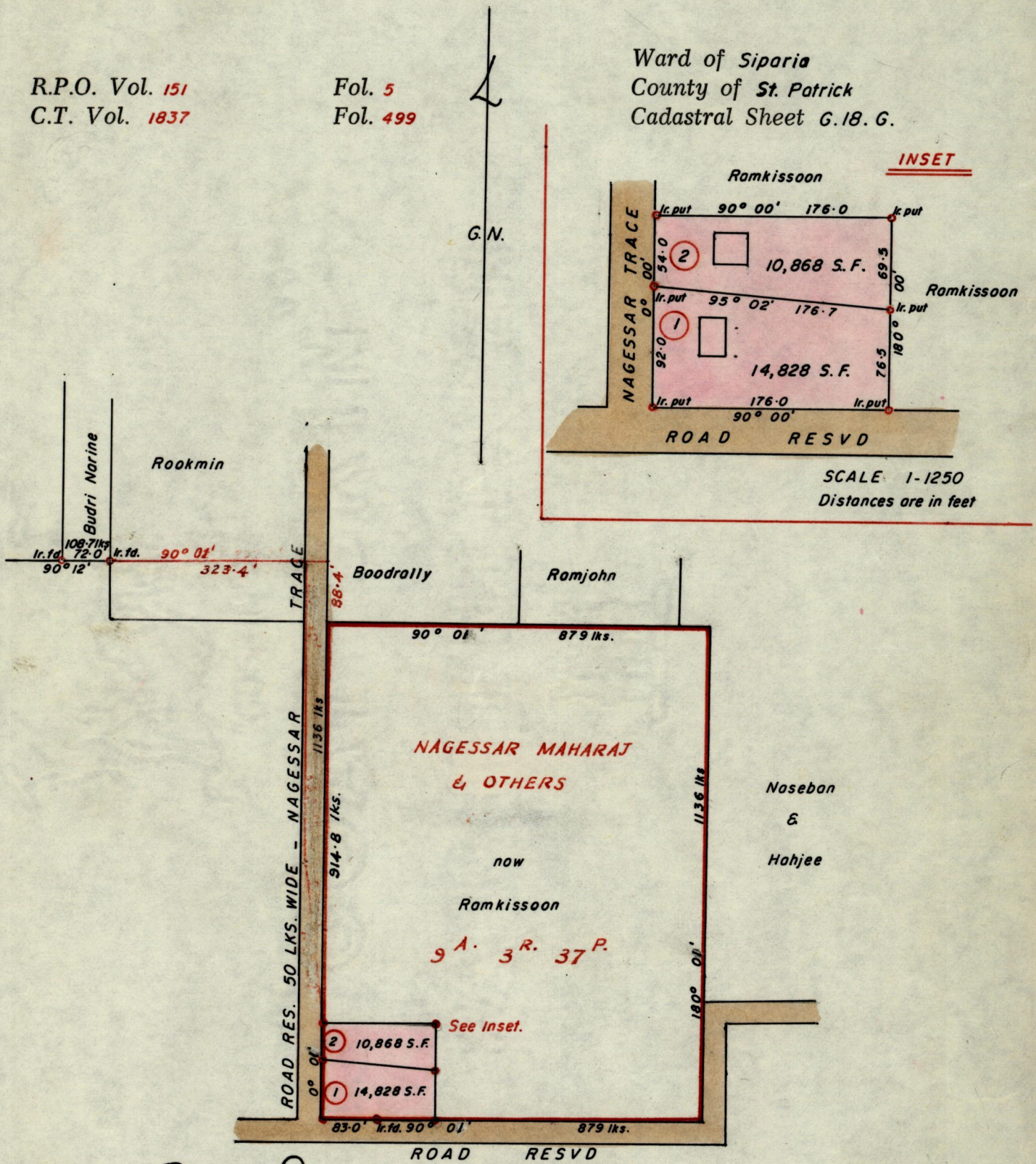

SCALE 1-1250  
Distances are in feet

Approved *[Signature]*  
Director of Surveys  
82.02.02.

SCALE 1-2500

Bearings are based on Solar Observations  
Note: To obtain compass bearings add/subtract

minutes

Distances are in feet & links

PLAN of a Parcel of land coloured pink in the Ward of Siparia  
Containing together Twenty five thousand six hundred and ninety-six square feet  
Surveyed by me, with due authority, in March 1981

I certify that I have complied with rule 76 under section 14(2)(d) of the  
Land Surveyors' Ordinance 1952, and that this plan is correct.

Checked by *[Signature]* 29/11/82

*[Signature]*

Entered .....

Land Surveyor, Trinidad 8/7/1981